

59

Academic

O6A Series

PENDANT - SURFACE - WALL - VARIABLE

 **Metalumen**

Ideas brought to light



O6S Surface

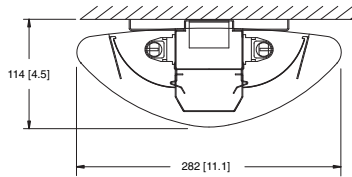

O6W Wall

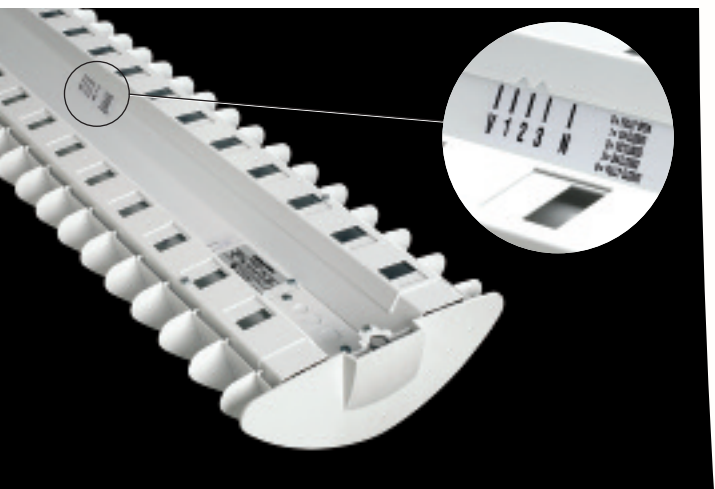
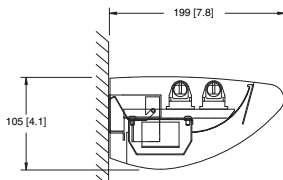

O6A Variable distribution, pendant only - 2 lamp maximum

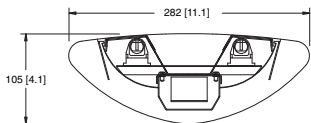

O6A Variable distribution

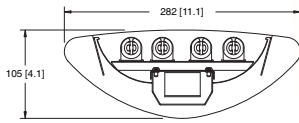

O6A Pendant

The Academic is reminiscent of the old school baffle fixture, a design classic that has been updated by Metalumen to create an architectural direct/indirect luminaire that is truly of the new school. The Academic delivers lighting efficiencies up to 92%; lighting distributions of up to 30% Down / 70% Up without supplementary reflectors; an exact 4-foot module for all 4-, 8- and 12-foot fixture sections, and; a universal product design that allows all fixtures to be placed anywhere in a continuous run¹. Combine these features with a single cross-section that accepts 1-, 2-, 3- or 4-lamps with T8, T5 or T5HO lamping and the Academic represents versatility and value in a single luminaire that is capable of outstanding performance in the classroom, open plan office or high ceiling application.

Construction and Finish

The Academic is a direct/indirect luminaire with a cross-section of 11.1" x 4.1", a formed steel center ballast channel and integrated die-formed steel baffles. Modular fixture section lengths offer standard 4'0", 8'0" and 12'0" hanger spacing that aligns with most ceiling grid systems. The modular and universal design of each Academic luminaire means that continuous runs can be created using any combination of 4-, 8- and 12-foot luminaires, placing individual fixtures at any position within the run. The end of each fixture run is completed with a sculpted, injection molded end cap that is secured with a simple snap fit without exposed fasteners.

A white polyester powder coated paint finish with 91% reflectance is the standard finish. Optional custom colors are available. Consult factory for custom finishes.

Models:

- **O6A Pendant** – Up to 4 - T5, T5HO or T8 lamps.
- **O6A Variable distribution** – Field adjustable top reflector provides variable distributions from 93% Direct / 7% Indirect to 67% Direct / 33% Indirect. 2 - T5, T5HO or T8 lamps.
- **O6W Wall** – Matching wall bracket with 1 or 2 - T5, T5HO or T8 lamps.
- **O6S Surface** – Matching surface with 2 - T5, T5HO or T8 lamps.

Mounting

Solid stem 13mm (1/2") OD or yoke aircraft cable complete with a Quick-Grip field adjustable suspension system provides for fast and easy on-site alignment. All 4-, 8- and 12-foot fixture sections have an exact 4-foot module hanger spacing that aligns with most ceiling grid systems.

Lighting Control Options

Solid cross blade baffle

(Standard with T8 lamping)

Solid cross blade baffle: opal overlay

(Standard with T5, T5HO lamping)

Electrical

Fixtures are pre-wired for quick connection of individual sections and continuous runs. Specify integral, slim size, electronic ballast at 120, 277 and 347 volts. For multiple circuits, dimming, motion sensor, battery pack and emergency circuit applications, please consult factory.

All fixtures UL and CSA listed.

¹ All fixtures may be powered at either end and all fixtures accept the 'snap-in' end-of-run trim.

Please refer to black and white ordering guides for detailed product information.

For IES files with additional lamping and control options go to www.metalumen.com/ies

All dimensions are nominal and subject to tolerances. We reserve the right to make changes that will not alter installed appearance, function, or performance. These designs remain the property of Metalumen. We reserve the exclusive right to reproduce them and to manufacture the items illustrated herein. Some combinations may not be available, consult factory. METALUMEN™ is a registered trademark of Metalumen Manufacturing Inc.



570 Southgate Drive, Guelph, Ontario N1G 4P6
 Mailing Address: P. O. Box 1779, Guelph, Ontario N1H 6Z9
 T: 800-621-6785 T: 519-822-4381 F: 519-822-4589

www.metalumen.com