

# 6

## Finesse

C7S:W Series

*The FINESSE Series family of pendants, wall sconces and wall brackets offer a discrete, subtle profile with an edge casting only 32mm (1.2") high.*

**METALUMEN**  
Distinguished Design ↔ Engineered Excellence

[www.metalumen.com](http://www.metalumen.com)

# Finesse

C7S:W Series



## Finesse Series: C7S, Pendants; C7W Wall Brackets

The *Finesse C7 Series* is constructed of formed aluminum with die cast end caps forming a discrete radiused profile. With control options including perforated body, angled slots, and solid body with matching wall brackets and wall sconces, Finesse is a versatile family of luminaires.

**Above**  
C7S Slots  
C7S Solid body  
C7S Perforated body

**Cover**  
C7S Perforated body

**METALUMEN**  
Distinguished Design ↔ Engineered Excellence

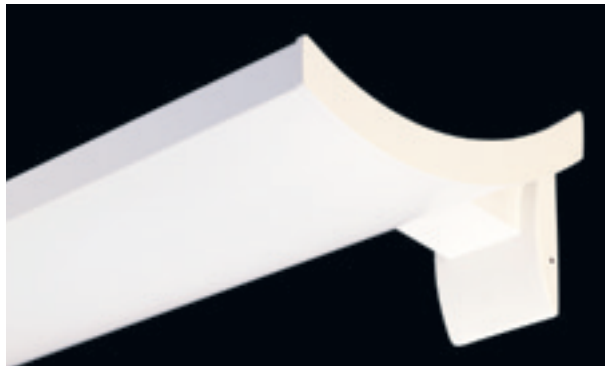

1



2

- 1. C7W Wall Bracket
- 2. C7W Wall Sconce

Above  
Trans Canada Tower

# Finesse

## C7S:W Series

### C7S

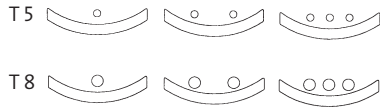
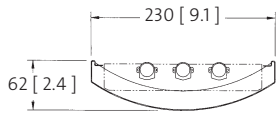

### C7W(A)

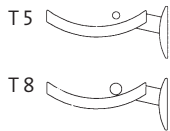
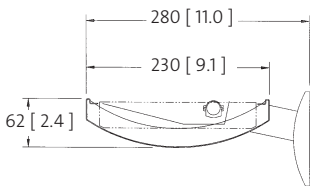

### C7W(S)

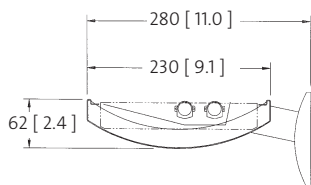

### Construction

Pendants - The structural integrity of the luminaire is provided by a formed aluminum 18 gauge body, 62mm (2.4") high x 230mm (9.1") wide with 16 gauge steel internal support brackets, and ballast cover.

The fixture's formed ballast channel, in conjunction with the die cast end caps, offers strength for sections as long as a nominal 3660mm 12'-0". With only two (2) hanger assemblies, straight alignment for continuous row installations can be maintained with a minimal amount of supports.

METALUMEN'S integrated tongue and groove electrical/mechanical inter-lock ensure straight runs for continuous run applications providing for a cost-effective installation. No disassembly of the product is required during installation.

Wall Brackets - The C7W (A) wall bracket and C7W (S) wall sconce are companions to the Finesse series. Ideal for indirect lighting of corridor, stairway and individual office lighting with the solid body option.

Mounting plates are supplied with fixtures.

### Mounting

Solid stem 10mm (3/8") OD, or aircraft cable complete with Quick-Grip field adjustment suspension system provides easy on-site alignments.

### Finish

Standard: White, baked, powder coated polyester finish. Gloss 85%.

Custom colors available - consult factory.

### Lighting Control Options

Perforated body.

Perforated body with unperforated band at center socket locations (consult factory for availability).

Solid body: 100% uplight

Angled slotted bottom and opal inlay.

Clear dust covers.

Opal insert: To mount between the lamps and the lower light controls.

### Certification

All fixtures are CSA and UL listed.

### Optics

Pendants - Computer modeled, formed painted steel materials are utilized to provide wide, horizontal indirect distribution. The C7S perforated body series provides approximately 5% downlight and meets IES RP-1 Recommended Practice with select lamping and lighting controls.

Wall Brackets - Specular aluminum, computer modeled reflector assembly has been incorporated for asymmetric distribution.

### Electrical

Integral, slim size, electronic ballast for T5 and T8 lamps at 120, 277 and 347 volts. Pre-wired for quick connection of individual sections and continuous runs to minimize installation time. No disassembly of the product is required. For multiple circuit, battery pack and emergency circuit wiring-consult factory. Pendants: Can accommodate up to three (3) T5 or T8 lamps, provided by others. Wall Brackets: C7W(A) (1) T5 or T8, Wall Sconce: C7W (S) 1 or 2-G9-Max.

# METALUMEN

Distinguished Design ↔ Engineered Excellence

METALUMEN MANUFACTURING INC.

570 Southgate Drive, Guelph, Ontario N1G 4P6

Mailing Address: P.O. Box 1779, Guelph, Ontario N1H 6Z9

toll free 1-800-621-6785 t 519-822-4381 f 519-822-4589

[www.metalumen.com](http://www.metalumen.com)

Please refer to black and white ordering guide for detailed product information and photometrics or visit our web site at [www.metalumen.com](http://www.metalumen.com)

All dimensions are nominal and subject to tolerances. We reserve the right to make changes that will not alter installed appearance, function, or performance. These designs remain the property of Metalumen. We reserve the exclusive right to reproduce them and to manufacture the items illustrated herein. Some combinations may not be available, consult factory. METALUMEN™ is a registered trademark. © 2001 Metalumen Manufacturing Inc.