



NOTE: The following instructions provide general guidelines for product installation. For additional information consult the applicable electrical codes or contact factory directly for support before attempting anything with uncertainty.

CAUTION: Do not assemble fixture runs on floor.

WARNING: Risk of fire and electrical shock. **DISCONNECT POWER AT ELECTRICAL PANEL** before installing or servicing this product.

GENERAL SAFETY INSTRUCTIONS:

1. Read all instructions prior to installing this fixture.
2. This product must be installed in accordance with the applicable installation code by a person familiar with the construction and operation of the product and the hazards involved.
3. All wiring must be performed by a qualified electrician in accordance with national and local building and electrical codes.
4. This fixture must be suitably grounded for your protection against shock hazards and to assure proper operation.
5. Make sure that the power source conforms to the requirements of this fixture.

Specifications and design subject to change without notice.

PARTS LIST

MAIN PARTS

- A. Luminaire Enclosure
- B. Lens
- C. Aircraft Cable
- D. Power Cord
- E. Hanger Enclosure
- F. Canopy
- G. Hanger Bracket

OTHER PARTS

- Reflector/LED board assembly

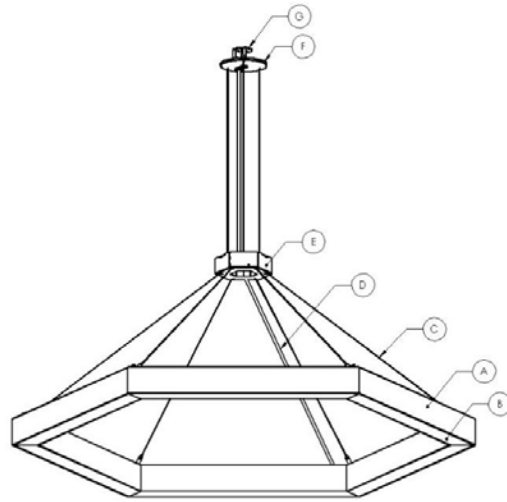

REQUIRED TOOLS

DRILL	#8 PHILLIPS BIT	#8 PHILLIPS SCREWDRIVER	WRENCH	#8 DEEP SOCKET

IMPORTANT: Use clean gloves to avoid adding oil/dirt to optics surface. Avoid scratching optics by using installation tools with soft plastic rounded edges

Specifications and design subject to change without notice.

WIRING DIAGRAMS

STANDARD WIRING

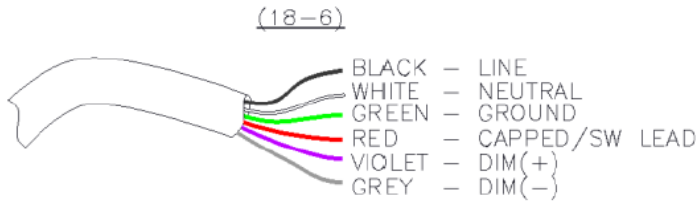

WITH OPTIONAL EMERGENCY CIRCUIT

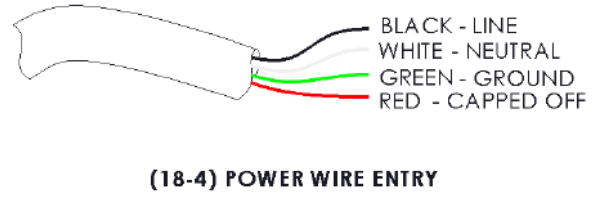

WITH OPTIONAL BATTERY PACK

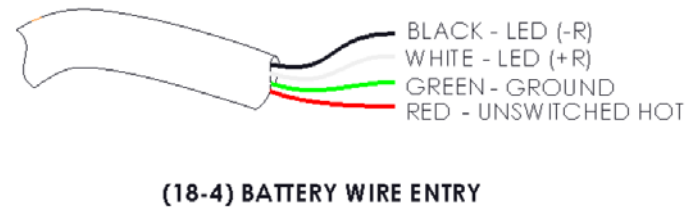

Specifications and design subject to change without notice.

JOINING INSTRUCTIONS

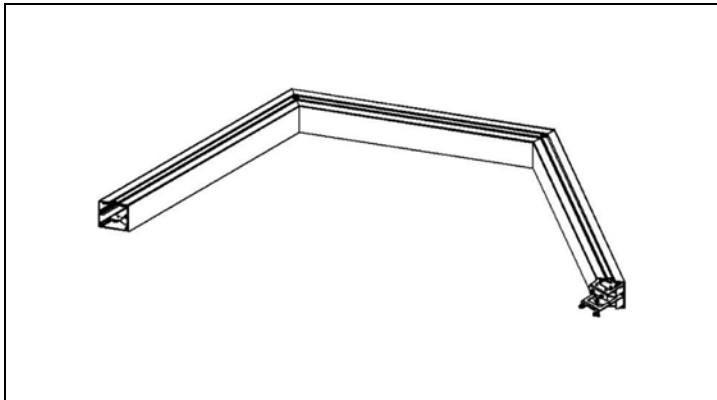

STEP 1. Remove fixture packaging; note marked supply wires coming out at the back of the luminaire.

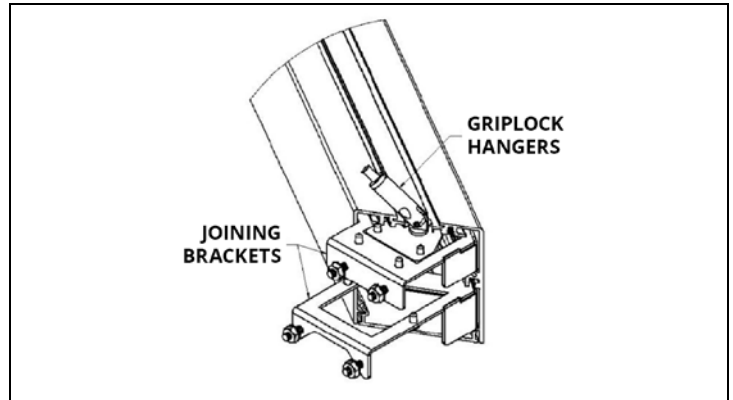

STEP 2. Install Griplocks into all six corners. Use Loctite to insure proper fastening. The Griplock must point towards the central axis of the fixture.

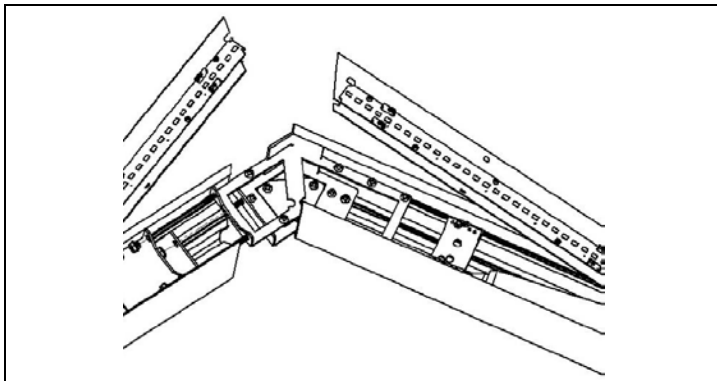

STEP 3. Remove lenses reflectors at the two joining sections. Join the two sections by sliding the two brackets into the adjoining section.

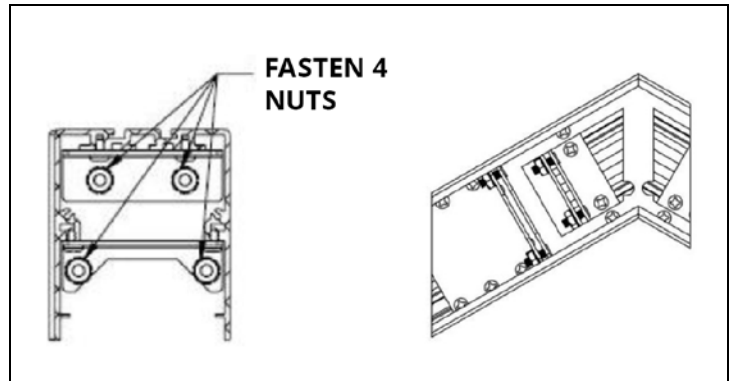

STEP 4. Fasten the nuts at the joining brackets to ensure a tight fit. Re-install the reflectors and the lenses.

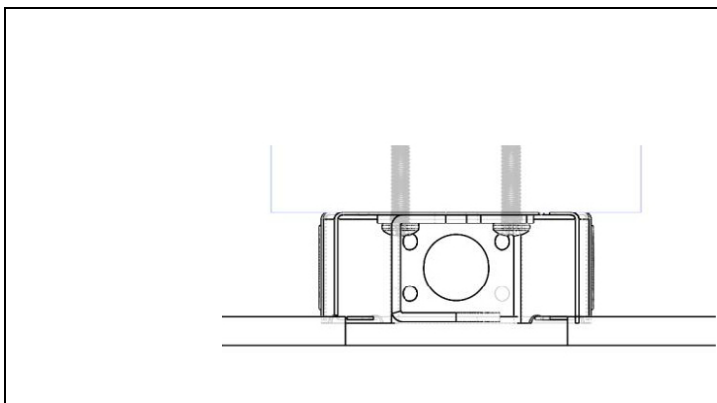

HANGER BRACKET must point in the direction of the run. This will allow for the hanger location to be modified in order to keep it plumb.

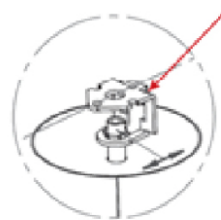

STEP 5. Install hanger brackets for the fixture. Adjust height of the fixture using the top three aircraft cables.

Specifications and design subject to change without notice.