



NOTE: The following instructions provide general guidelines for product installation. For additional information consult the applicable electrical codes or contact factory directly for support before attempting anything with uncertainty.

CAUTION: Do not assemble fixture runs on floor.

WARNING: Risk of fire and electrical shock. **DISCONNECT POWER AT ELECTRICAL PANEL** before installing or servicing this product.

GENERAL SAFETY INSTRUCTIONS:

1. Read all instructions prior to installing this fixture.
2. This product must be installed in accordance with the applicable installation code by a person familiar with the construction and operation of the product and the hazards involved.
3. All wiring must be performed by a qualified electrician in accordance with national and local building and electrical codes.
4. This fixture must be suitably grounded for your protection against shock hazards and to assure proper operation.
5. Make sure that the power source conforms to the requirements of this fixture.

Specifications and design subject to change without notice.

PARTS LIST
MAIN PARTS

- A. Luminaire Enclosure
- B. T-Bar Hanger Bracket
- C. End Plate
- D. Retainer Clip
- E. Lens
- F. Lens Filler & Magnet (if applicable)

OTHER PARTS

- Reflector/LED board assembly

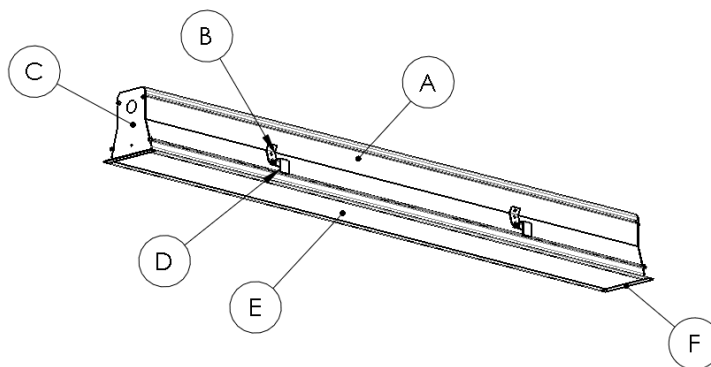
REQUIRED TOOLS

DRILL	#8 PHILLIPS BIT	#8 PHILLIPS SCREWDRIVER	WRENCH

Important: Use clean gloves to avoid adding oil/dirt to optics surface. Avoid scratching optics by using installation tools with soft plastic rounded edges

WIRING DIAGRAMS

STANDARD WIRING	WITH OPTIONAL EMERGENCY PACK
<p>WIRE ENTRY 5 LEADS</p>	

Specifications and design subject to change without notice.

WITH OPTIONAL BATTERY PACK

(4) LEADS

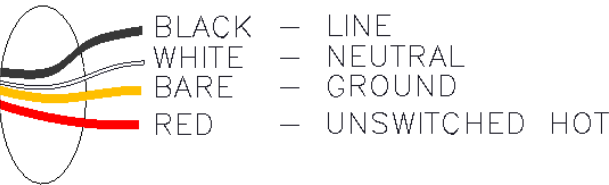

Specifications and design subject to change without notice.

STEP-BY-STEP INSTRUCTIONS

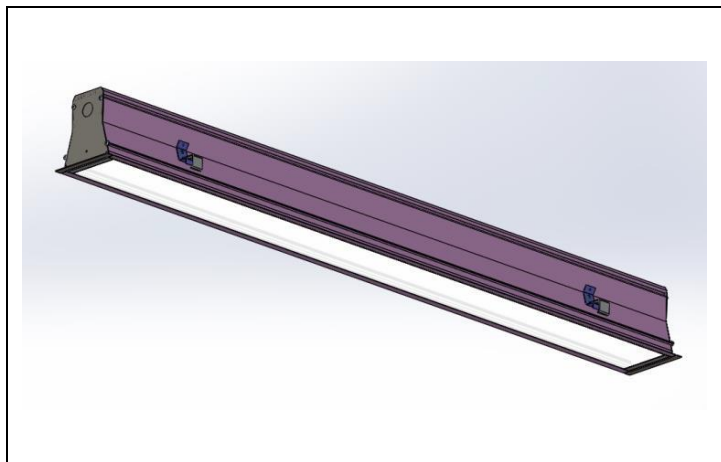

STEP 1. Remove fixture packaging; note marked supply wires coming out at one end of the luminaire.

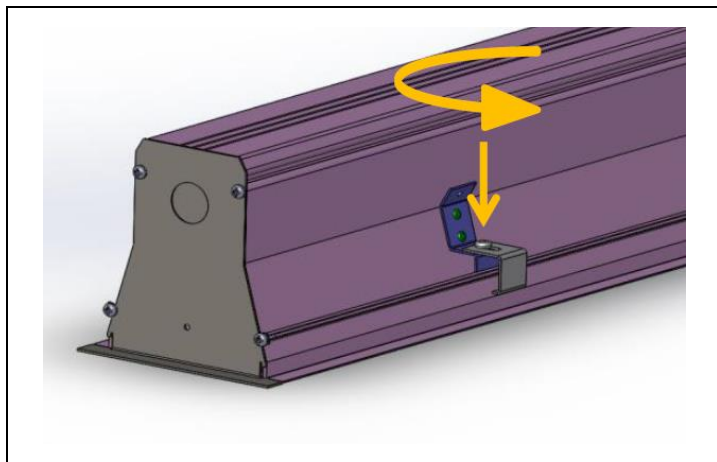

STEP 2. Ensure retainer clip (D) is loose. If not, loosen retainer clips (4).

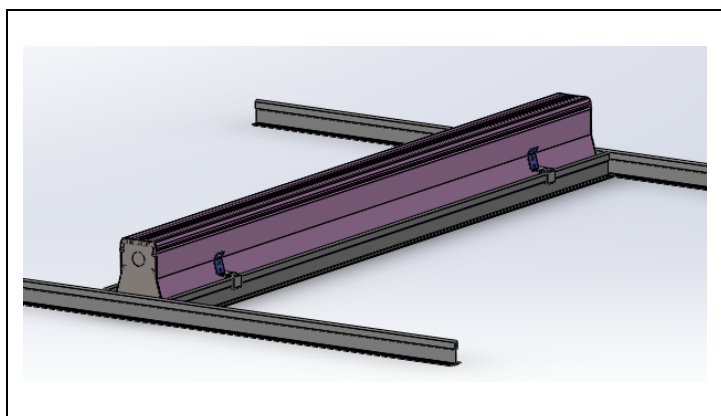

STEP 3. Place luminaire fixture (A) into ceiling and rest it onto the T-bar using the hanger bracket (B) and retainer clip.

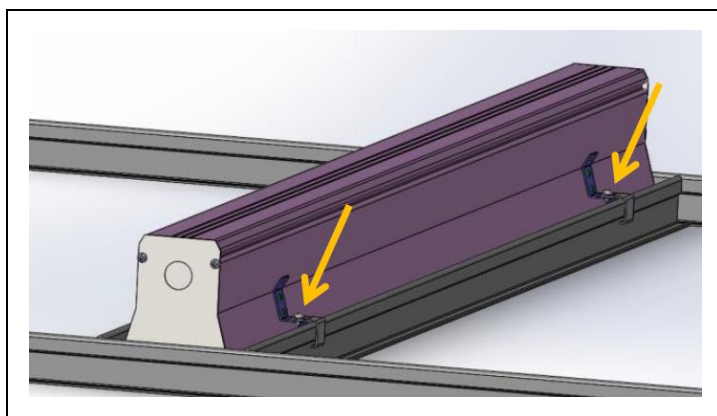

STEP 4. Adjust retainer clips so it sits tight against the T-bar.

Specifications and design subject to change without notice.

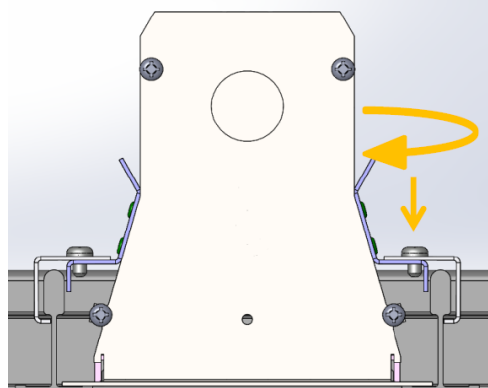

STEP 5. Once retainer clips are tight against the T-bar, fasten screws to secure retainer clips in location.

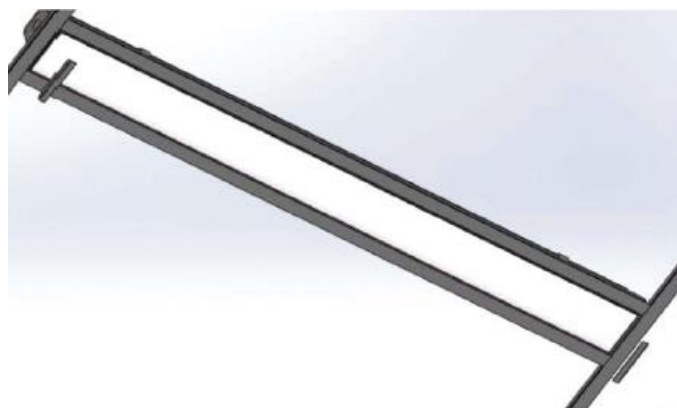

STEP 6. Remove lens filler and magnet (F) (if applicable).

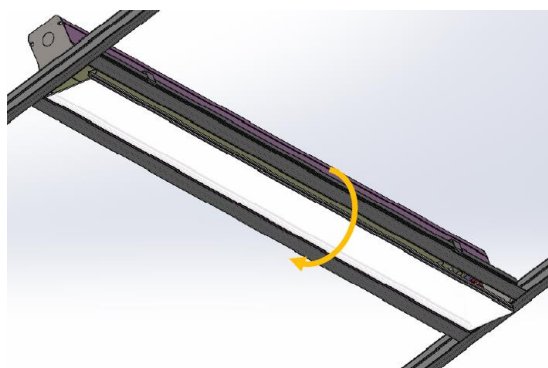

STEP 7. Remove lens (E) starting at one end. Pull one side first, rotate and detach. Keep lens.

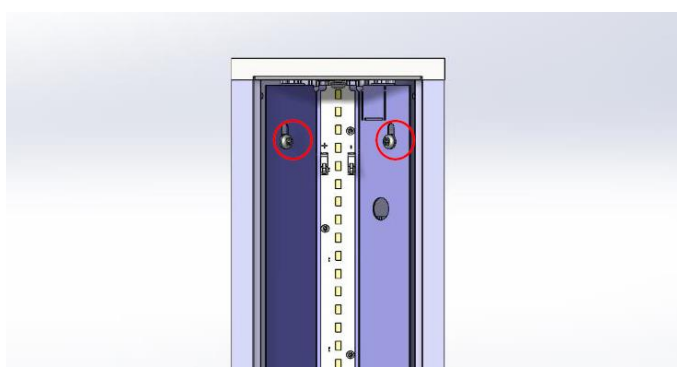

STEP 8. Remove reflector mounting screws.

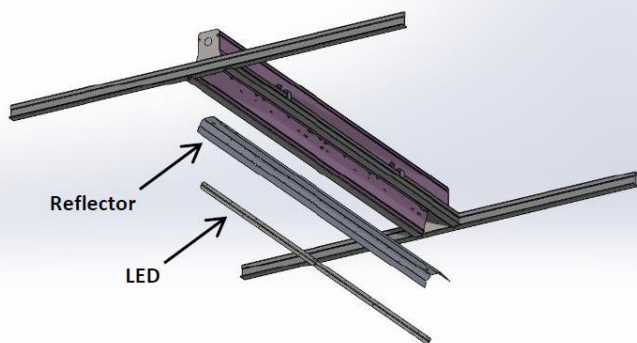

STEP 9. Remove reflector and LED assembly from unit. Note fixtures with optional emergency pack have a test switch and indicator light mounted on the reflector.

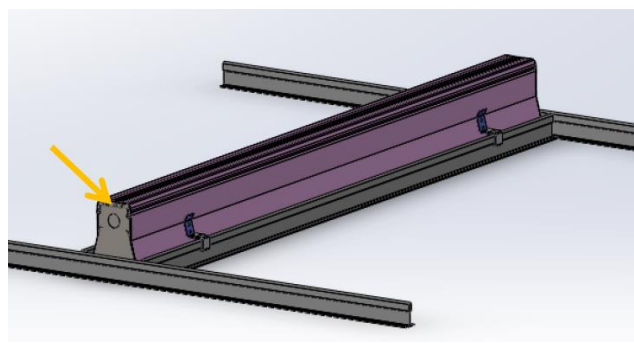

STEP 10. Bring electrical supply to the fixture as needed. Make sure all retaining clips are secured and fastened.

Specifications and design subject to change without notice.

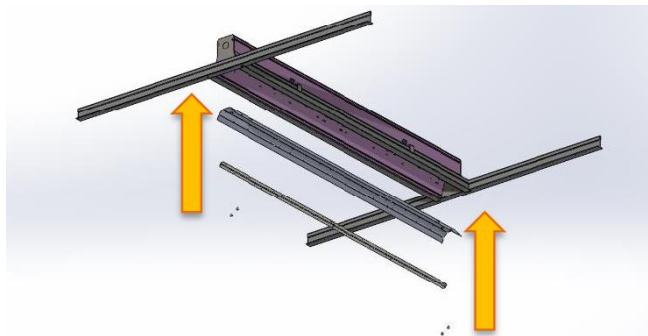

STEP 11. Perform electrical wiring inside the fixture. Optional emergency driver must be fed from the same branch circuit as the AC driver. Re-attach reflector/LED assembly with mounting screws.

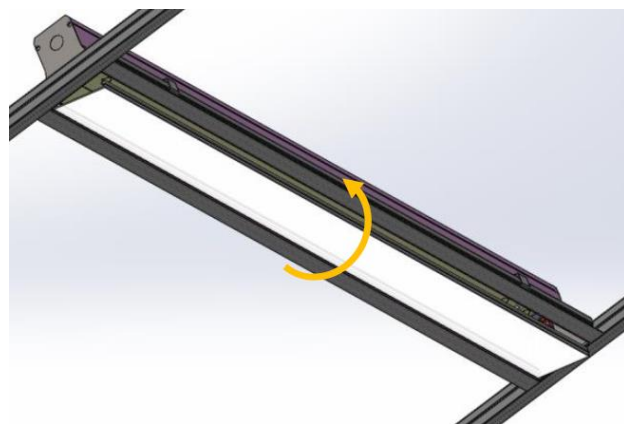

STEP 12. Re-attach lens. Start with one side first and close the other side starting from the corner.

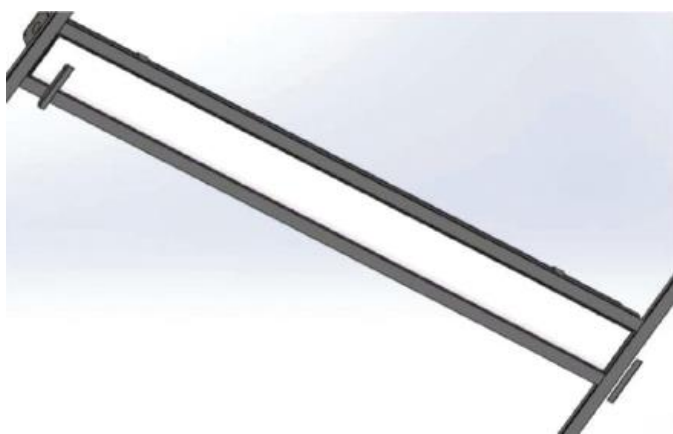

STEP 13. Re-attach the filler and magnet.



STEP 14. Installed fixture.

Specifications and design subject to change without notice.

JOINING INSTRUCTIONS

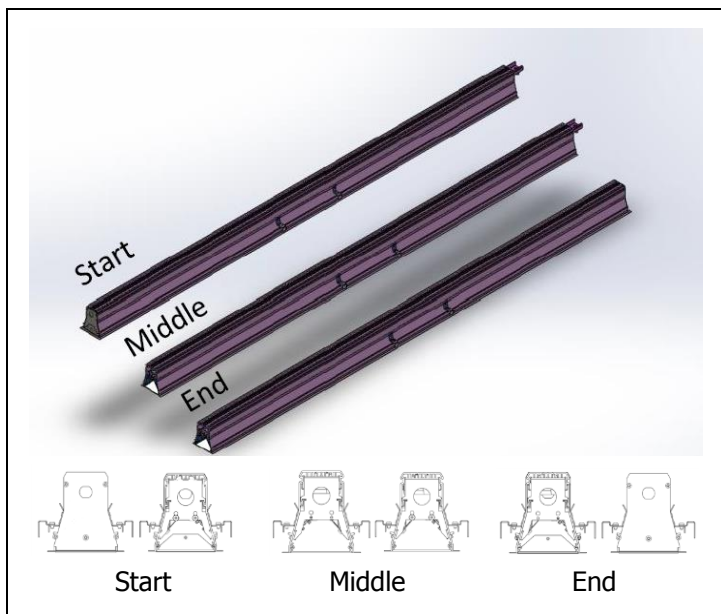

STEP 1. Remove fixture packaging; note marked supply wires coming out of one end of the Start luminaire and wires for row mounting connections at the opposite end.

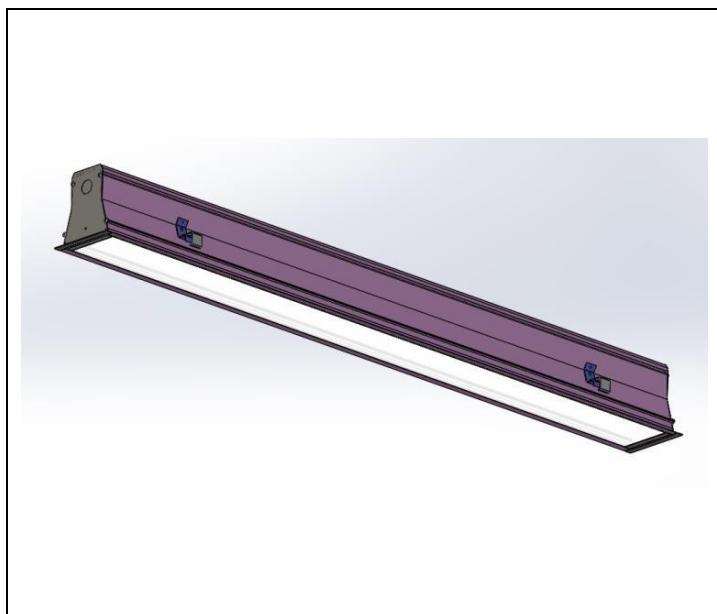

STEP 2. Install Start luminaire following standard installation instructions. Do not apply power.

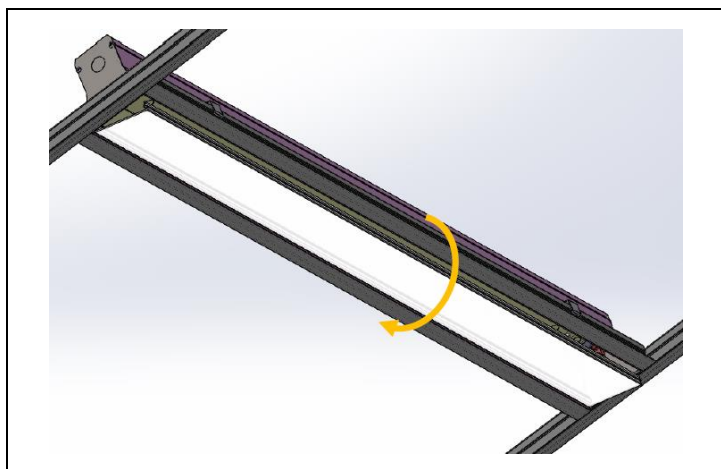

STEP 3. Remove lens filler and magnet (if applicable). Remove lens starting at one end. Pull one side first, rotate and detach. Keep lens.

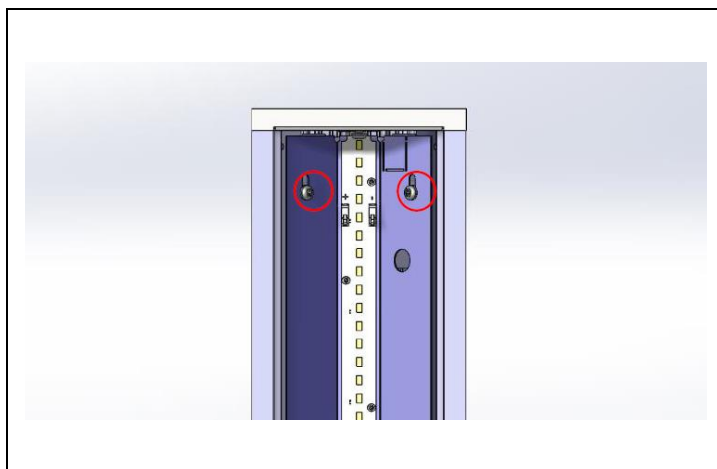

STEP 4. Remove reflector mounting screws.

Specifications and design subject to change without notice.

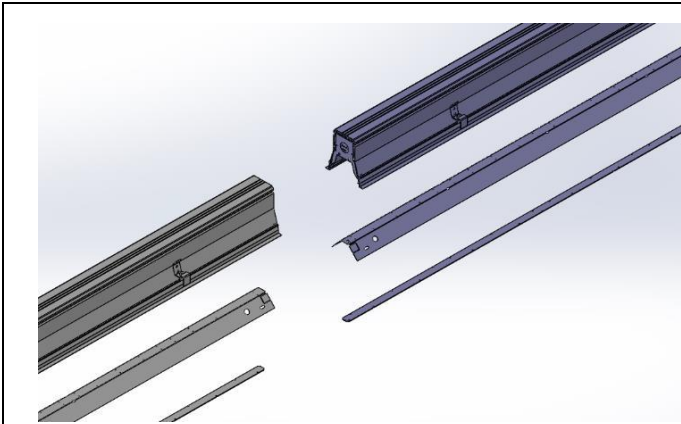

STEP 5. Remove reflector and LED assembly on joining ends to access the joining brackets.

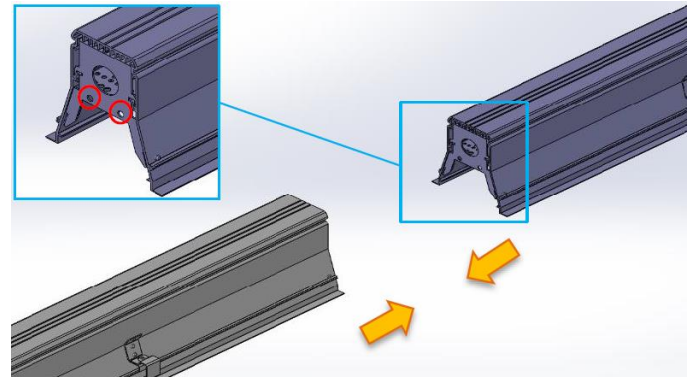

STEP 6. Align mid/end fixture and slide it into place. Secure with joining hardware. Reinstall reflector assembly and lens in both fixtures. Perform necessary wiring between fixtures. Repeat steps for remaining fixtures.

Specifications and design subject to change without notice.

MAINTENANCE

REQUIRED TOOLS:

- Plastic / Latex Gloves
- Screwdriver

Important: Use clean gloves to avoid adding oil/dirt to reflector surface. Avoid scratching reflector surface by using installation tools with soft plastic rounded edges.

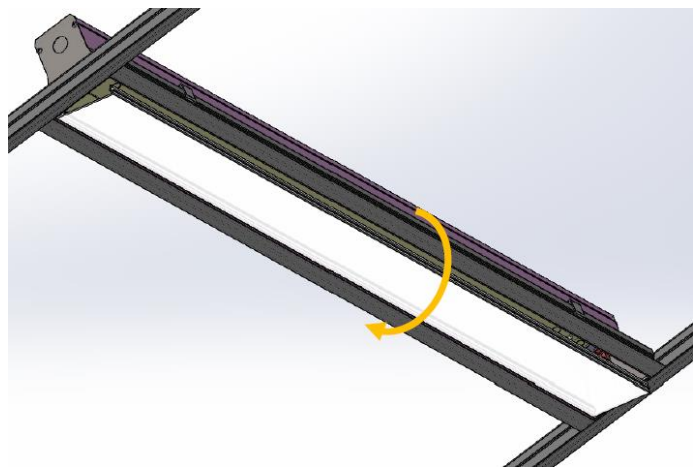

STEP 1. For LED board maintenance, remove the lens filler and magnet (if applicable) and remove the lens from the bottom of the unit. The LED boards are now accessible.

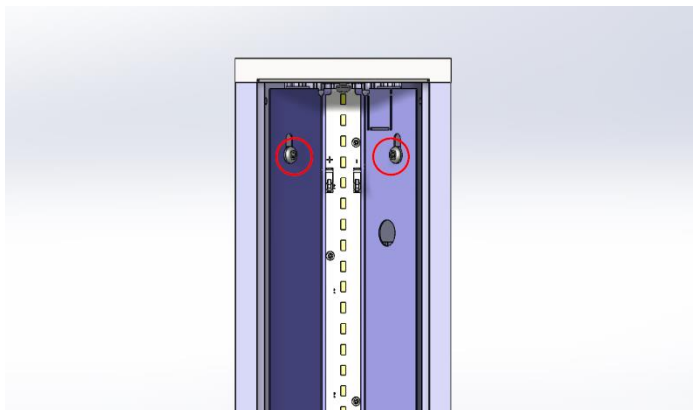

STEP 2. For driver maintenance, unscrew the reflector assembly.

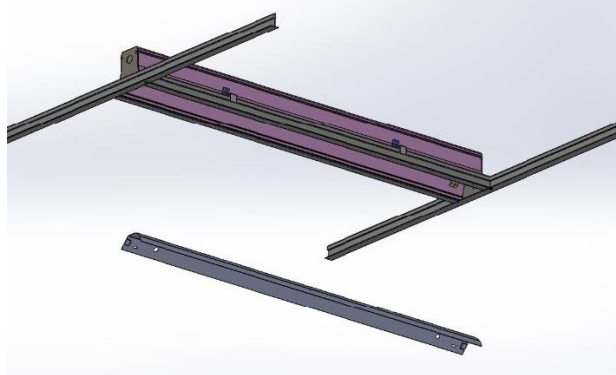

STEP 3. Remove reflector and LED assembly from unit.

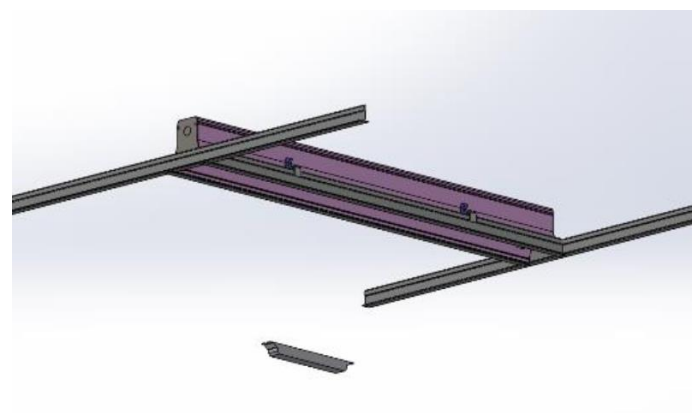

STEP 4. Remove and service driver as required.

Specifications and design subject to change without notice.