

IS-NATA-SW-01 (Rev.02)
NATA SERIES SINGLE WALL MOUNT
DIRECT-INDIRECT/INDIRECT INTEGRAL/REMOTE DRIVER
INSTALLATION INSTRUCTIONS

NOTE:

The following instructions provide general guidelines for product installation. These instructions apply to NATA fixtures. For additional information, consult the applicable electrical codes or contact the factory directly for support before attempting anything with uncertainty.

WARNING:

Risk of fire and electrical shock. **DISCONNECT POWER AT ELECTRICAL PANEL** before installing or servicing this product.

GENERAL SAFETY INSTRUCTIONS:

- Read all instructions prior to installing this fixture.
- This product must be installed in accordance with the applicable installation code by a person familiar with the construction and operation of the product and the hazards involved.
- All wiring must be performed by a qualified electrician in accordance with national and local building and electrical codes.
- This fixture must be suitably grounded for your protection against shock hazards and to assure proper operation.
- Make sure that the power source conforms to the requirements of this fixture.
- Class 1 luminaire.
- The Minimum installation height must be 12' from the floor.
- Fixtures can only be serviced by certified personnel.

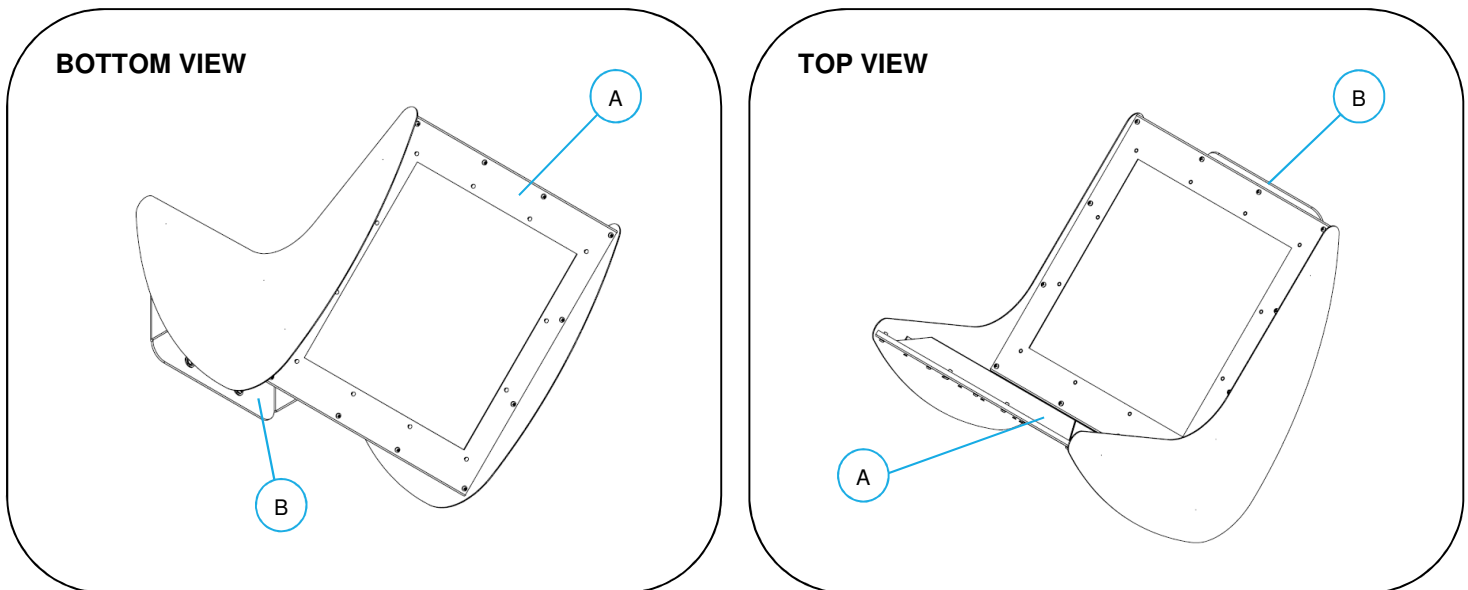

DIRECT-INDIRECT INTEGRAL/REMOTE DRIVER
PARTS LIST:

- A – Luminaire fixture
B – Fixture mounting bracket

BOTTOM VIEW

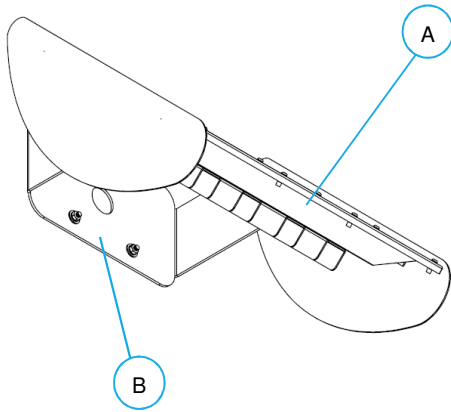

TOP VIEW

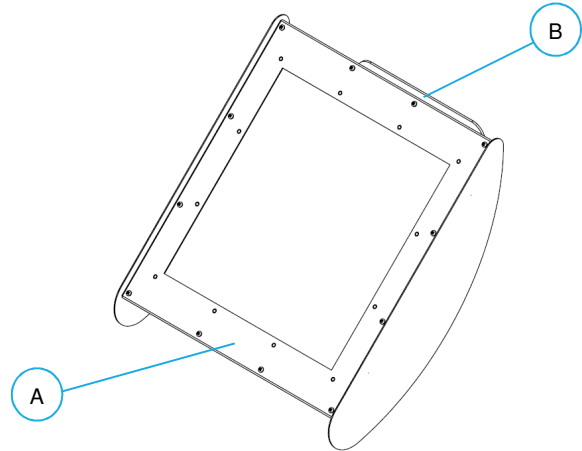

**INDIRECT INTEGRAL/REMOTE DRIVER
PARTS LIST:**

- A – Luminaire fixture
- B – Fixture mounting bracket

WIRING DIAGRAM – (COLOR CODED)



REMOTE/INTEGRAL DRIVER TO LINE VOLTAGE

Image #1

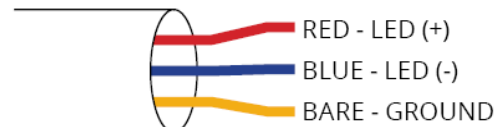

FIXTURE TO REMOTE DRIVER BOX

Image #2

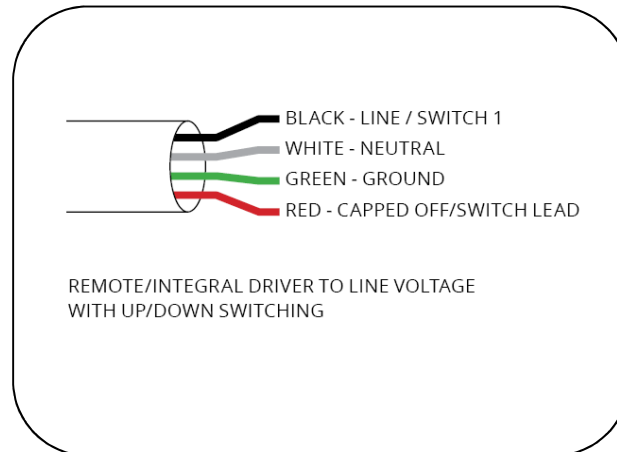
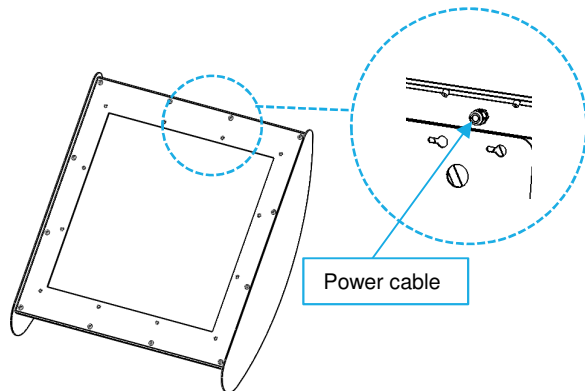

Image #3

INSTALLATION STEPS

Step 1: Remove the fixture from the packaging. Note that the power cable comes out from back of this fixture.



Step 2: Feed cable through fixture mounting hole Wire Entry and position fixture near a mounting location.

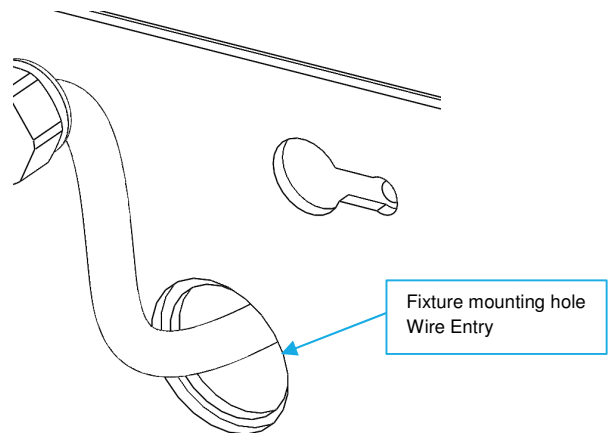

Step 3: Wire fixture using Waterproof Marrette (Supplied by Others). Refer to provided wiring diagram (Color Coded): (**Image #1** for integral with dimming) **Image #3** for integral with up/down switching) & **Image #3** for remote). Enclose wire connections into the junction box (Supplied by Others).

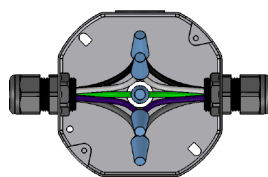

Figure 1 for integral with dimming

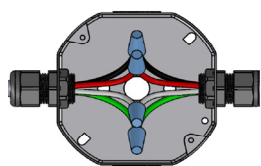

Figure 3 for integral with up/down switching

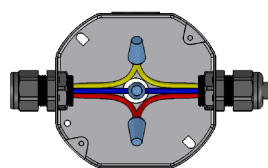
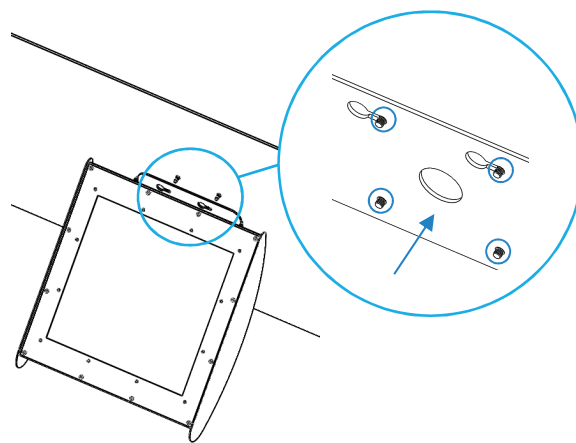
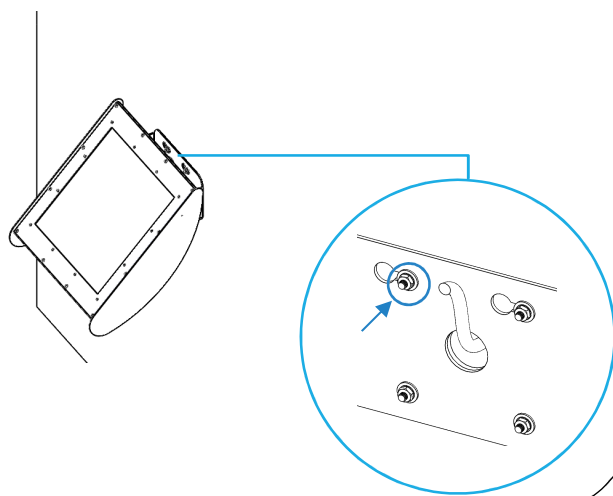

Figure 2 for remote

Step 4: Mount the fixture by aligning holes on the fixture mount with mounting hardware (Supplied by Others) and secure it to the wall.



Step 5: Secure fixture to the wall using recommended #1/4-20 hardware (Supplied by Others).



Step 6: For remote driver configuration, install the remote driver box at a suitable location structural by using recommended #1/4-20 hardware (Supplied by Others) - (Watertight BX-cable connector Supply by Others)

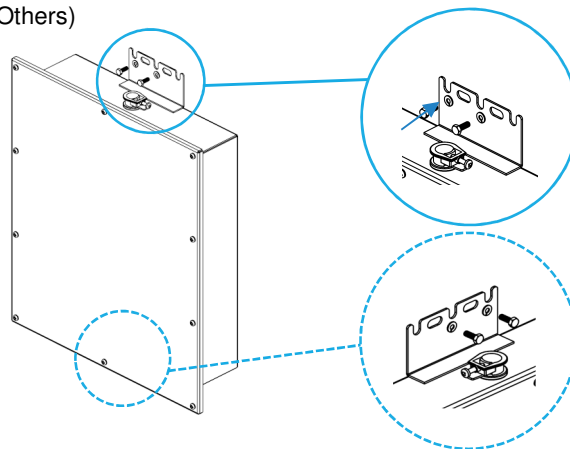

Step 7: Connect wires from the driver to the fixture using Waterproof Marrette (Supplied by Others) inside the driver box through Watertight BX-cable connector (Supplied by Others). Refer to wiring diagram (**Figure 2**).

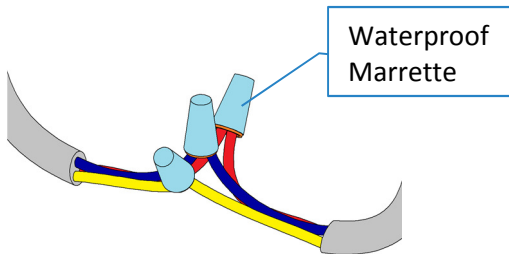

Step 8: Connect wires from the driver to the control panel using Waterproof Marrette (Supplied by Others) inside the driver box. Refer to the wiring diagram (**Figure 1**) for dimming.

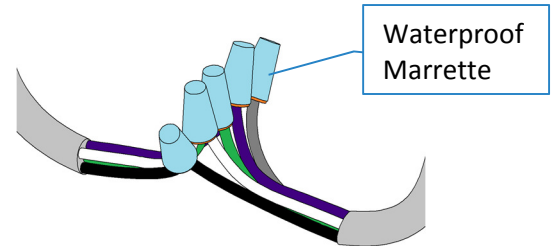

Refer to wiring diagram (**Figure 3**) for up/down switching.

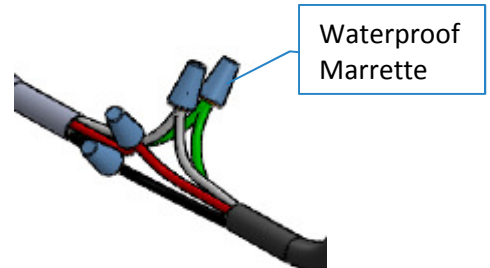

MAINTENANCE STEPS

Required Tools:



PLASTIC / LATEX GLOVES



SCREWDRIVER

*Important: Use clean gloves to avoid adding oil/dirt to the optics.
Avoid scratching optics by using installation tools with soft plastic rounded edges.*

To Clean the Optics (from OUTSIDE ONLY):

- Gently wipe down the optics with a clean, dry cloth to remove dust and any light residues.
- For heavier smudges, spray clean cloth with mild soap and water solution and gently wipe optics surface.

WARNING: DO NOT OPEN THE FIXTURE for cleaning purpose. Hard wiping and abrasive cloths will scratch the optics.
DO NOT USE cleaning products containing alcohol or acetone. They will damage the optics.

Step 1: For LED board maintenance, remove the door assembly by loosening the mounting screws.

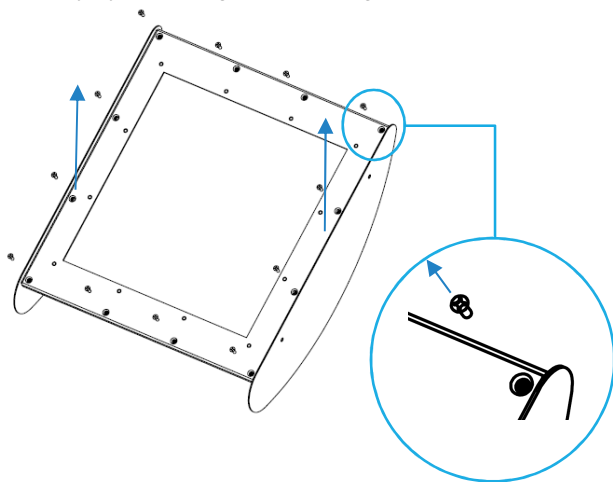

Step 2: Disconnect wires from LED boards before removing them. Unscrew the nuts to remove the LED boards from the fixture.

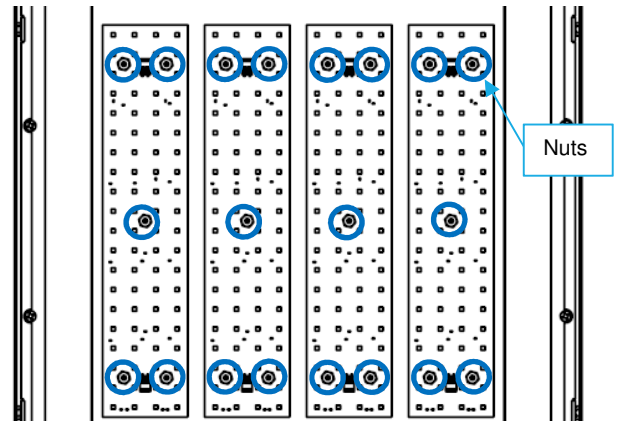

Step 3: For LED driver maintenance, loosen the screws that secure the driver box cover. Note that the driver box is found at the back of the fixture (integral) or in a remote location.

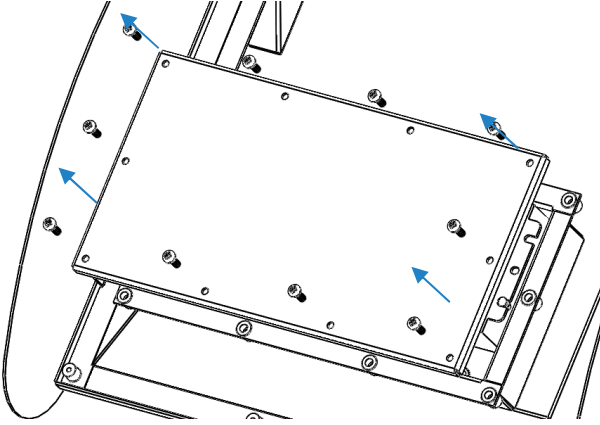

Step 4: Disconnect AC power and wire connections. Remove and service the LED driver as required.

