

# RAIL 4 RM4D

TUNABLE . WALL . DIRECT

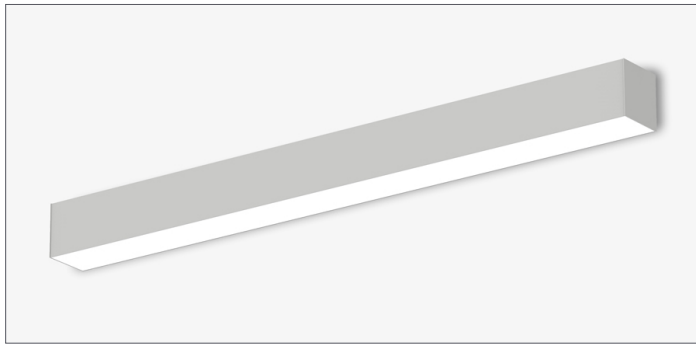

|                     |                    |
|---------------------|--------------------|
| PART #:             |                    |
| PREP BY:            | DATE:              |
| PROJECT:            |                    |
| NOTES:              |                    |
| APPROVAL SIGNATURE: | DATE (DD/MM/YYYY): |

PERFORMANCE SUMMARY @ 4000K

|                  |        | Meta Blanc (MB) | Drop Lens (MD) |
|------------------|--------|-----------------|----------------|
|                  |        | L3              | L3             |
| Lumens per foot  | 80 CRI | 547             | 577            |
|                  | 90 CRI | 481             | 507            |
| Wattage per foot |        | 6.2             |                |
| Efficacy         | 80 CRI | 88              | 93             |
|                  | 90 CRI | 77              | 81             |
| L70 Estimate (h) |        | >60,000 hrs     |                |

See page 2 for the complete Light Level Performance chart.

## FEATURES

- Independant control of intensity and correlated color temperature (CCT)
- Allows for scheduled mimicking of daylight color temperatures
- Dim-to-Warm simulates warmer CCT shift as luminaire dims (i.e. like traditional incandescent and halogen lights).

## ORDERING LOGIC

Example Part Number: RM4D-1LTUN-12-MB-W-L31-W-1-D-90

| RM4D   |  |                              |  |   |   |   |   |   |  |   |  |
|--|--|------------------------------|--|---|---|---|---|---|--|---|--|
| 1  | 2  | 3                            | 4  | 5   | 6 | 7   | 8 | 9   | 10   | 11  |  |
| 1. SERIES<br><b>RM4D</b>   | 2. COLOR TEMP<br><b>1LTUN</b> Tunable White (2700 - 6500K)<br><b>1LDW</b> Dim to Warm* (3500 - 2700K)<br>90 CRI is available under OPTIONS |                              | 3. LENGTH<br><b>2</b> 2 ft<br><b>3</b> 3 ft<br><b>4</b> 4 ft<br><b>5</b> 5 ft<br><b>6</b> 6 ft<br><b>7</b> 7 ft<br><b>8</b> 8 ft<br><b>9</b> 9 ft<br><b>10</b> 10 ft<br><b>11</b> 11 ft<br><b>12</b> 12 ft<br><b>RA</b> Continuous Rows<br>Replace "A" with length in feet selected in the Continuous Rows section |   |   | 4. OPTICS<br><b>MB</b> Meta Blanc<br><b>MD</b> Drop Lens<br><br><b>Meta Blanc, Drop Lens:</b> Opal diffuse lens   |   | 5. FINISH<br><b>SA</b> Satin Aluminum<br><b>W</b> White<br><b>B</b> Black<br><b>C</b> Custom Finish<br>Specify RAL: |  | 6. LIGHT LEVEL / DRIVER<br><b>L1</b><br><b>L2</b><br><b>L3</b><br><b>L4</b><br>Select Driver below.<br>See Light Level Performance chart below. |  |
| 7. CIRCUITRY<br><b>1</b> 1 Circuit<br><b>EM</b> Emergency / Night Light <sup>1</sup><br><b>B</b> Emergency Battery Pack <sup>2</sup> |  | 8. MOUNTING<br><b>W</b> Wall |  | 9. VOLTAGE<br><b>1</b> 120V<br><b>2</b> 277V<br><b>4</b> UNV (120 - 277V) |   | 10. CONTROLS / SENSORS<br>_ None (leave space empty)<br><b>D</b> Daylight Sensor**<br><b>O</b> Occupancy Sensor**<br><b>DO</b> Daylight and Occupancy Sensors** |   |   | 11. OPTIONS<br><b>90</b> 90 CRI, High R9<br>_ None (leave space empty) |   |  |

**PLEASE NOTE** Dim to Warm is not available with integrated sensors.  
Tunable White and Dim to Warm are available with emergency battery packs connected to the cool color LEDs only.

\* Consult factory for alternate options. | \*\* Controls intensity only (not CCT). | <sup>1</sup> Each EM pod, by default, has separate wire entry for DIM and CCT control. | <sup>2</sup> Battery operates 4ft sections only.

### Select Driver:

- Factory option dual 0-10V (Dim & CCT), 1% Dimming
- Lutron T Series EcoSystem, 1% Dimming
- DALI - Factory Option, DT6 Dual Address, 1% Dimming
- DALI - Factory Option, DT8 Single Address Color Control, 1% Dimming
- DALI - EdoLED

Light Level Performance at 4000K

| Meta Blanc (MB)             |        | 2700K        |     |     |     | 4000K |     |     |     | 6500K |     |     |      |
|-----------------------------|--------|--------------|-----|-----|-----|-------|-----|-----|-----|-------|-----|-----|------|
|                             |        | L1           | L2  | L3  | L4  | L1    | L2  | L3  | L4  | L1    | L2  | L3  | L4   |
| Total Lumens / foot (lm)    | 80 CRI | 297          | 374 | 502 | 694 | 323   | 407 | 547 | 789 | 327   | 411 | 551 | 779  |
|                             | 90 CRI | 261          | 329 | 441 | 610 | 284   | 358 | 481 | 693 | 287   | 361 | 484 | 685  |
| Wattage per foot            |        | 3.9          | 4.8 | 6.5 | 9.7 | 3.8   | 4.7 | 6.2 | 9.1 | 3.9   | 4.9 | 6.6 | 10.1 |
| Efficacy (lm/W)             | 80 CRI | 77           | 78  | 77  | 72  | 84    | 87  | 88  | 86  | 83    | 84  | 83  | 77   |
|                             | 90 CRI | 67           | 68  | 68  | 63  | 74    | 76  | 77  | 76  | 73    | 74  | 73  | 68   |
| Color Rendering (CRI)       |        | 80+          |     |     |     |       |     |     |     |       |     |     |      |
|                             |        | 90+          |     |     |     |       |     |     |     |       |     |     |      |
| L70 Estimate @ 25°C Ambient |        | > 60,000 hrs |     |     |     |       |     |     |     |       |     |     |      |

| Drop Lens (MD)              |        | 2700K        |     |     |     | 4000K |     |     |     | 6500K |     |     |      |
|-----------------------------|--------|--------------|-----|-----|-----|-------|-----|-----|-----|-------|-----|-----|------|
|                             |        | L1           | L2  | L3  | L4  | L1    | L2  | L3  | L4  | L1    | L2  | L3  | L4   |
| Total Lumens / foot (lm)    | 80 CRI | 314          | 395 | 527 | 731 | 341   | 429 | 577 | 830 | 346   | 434 | 578 | 813  |
|                             | 90 CRI | 276          | 347 | 463 | 643 | 300   | 377 | 507 | 729 | 304   | 381 | 508 | 715  |
| Wattage per foot            |        | 3.9          | 4.8 | 6.5 | 9.7 | 3.8   | 4.7 | 6.2 | 9.1 | 3.9   | 4.9 | 6.6 | 10.1 |
| Efficacy (lm/W)             | 80 CRI | 81           | 82  | 81  | 76  | 89    | 92  | 93  | 91  | 88    | 89  | 87  | 81   |
|                             | 90 CRI | 71           | 72  | 71  | 66  | 78    | 81  | 81  | 80  | 77    | 78  | 77  | 71   |
| Color Rendering (CRI)       |        | 80+          |     |     |     |       |     |     |     |       |     |     |      |
|                             |        | 90+          |     |     |     |       |     |     |     |       |     |     |      |
| L70 Estimate @ 25°C Ambient |        | > 60,000 hrs |     |     |     |       |     |     |     |       |     |     |      |

Metalumen's light level performance metrics are subject to manufacturers component tolerances.

WIRING

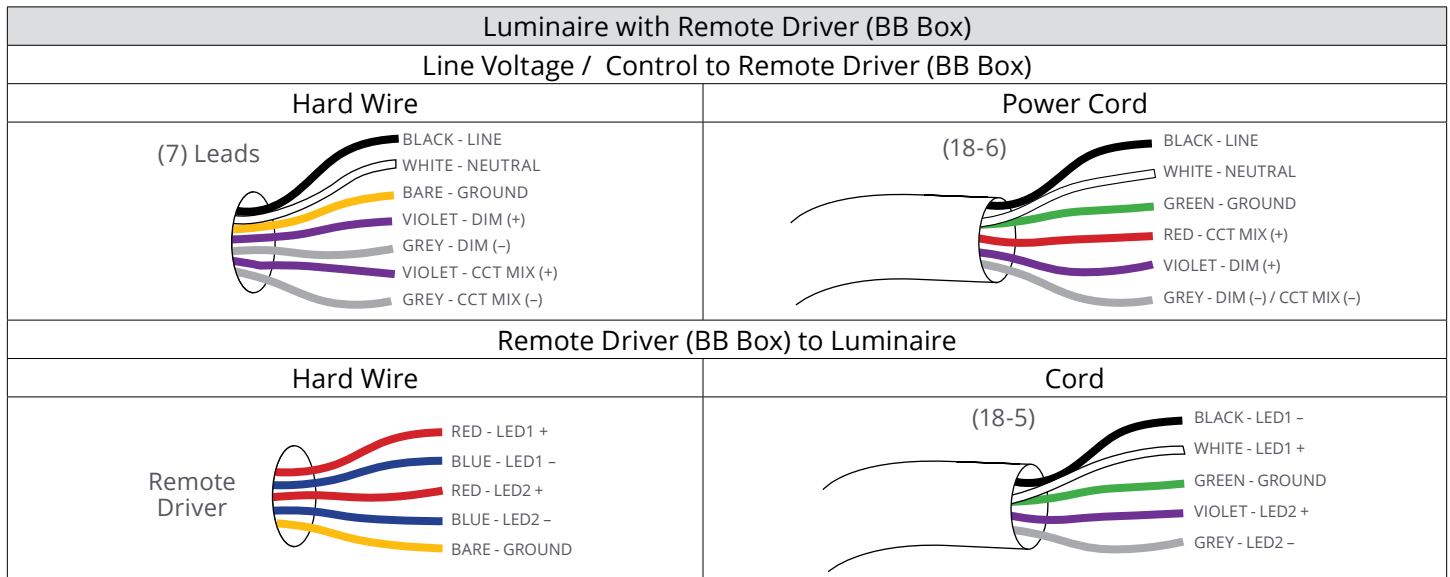
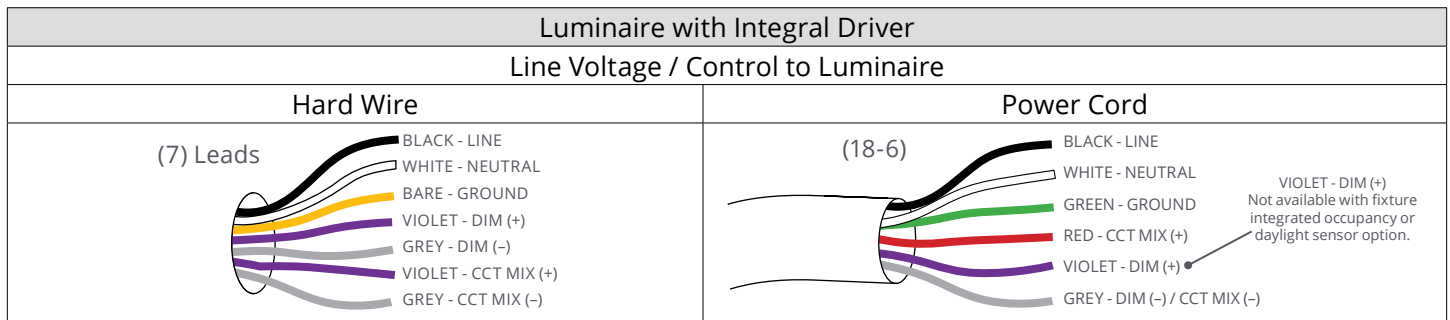

### CONTINUOUS ROWS

Step 1) Indicate desired quantity of rows under the QTY column

Step 2)  Pods  If applicable, select pod(s) per row to indicate desired Emergency lighting location. If a similar row requires a different Emergency lighting location, please fill out another sheet.

Record drawings for rows not represented here will be sent out upon order.

| QTY | Nominal Length | Run Length Overall | Alone / Start Length | Mid Length(s) | End Length | ROWS IN PLAN VIEW<br>Rows are for demonstration purposes only and are not to scale. |
|-----|----------------|--------------------|----------------------|---------------|------------|---|
| 4'  | 1225 [48.2]    | 4                  |                      |               |            |   |
| 8'  | 2442 [96.1]    | 8                  |                      |               |            |   |
| 12' | 3661 [144.1]   | 12                 |                      |               |            |   |
| 16' | 4881 [192.2]   | 8                  | 8                    |               |            |   |
| 20' | 6100 [240.2]   | 12                 | 8                    |               |            |   |
| 24' | 7319 [288.1]   | 12                 | 12                   |               |            |   |
| 28' | 8538 [336.1]   | 8                  | 12                   | 8             |            |   |
| 32' | 9757 [384.1]   | 12                 | 8                    | 12            |            |   |
| 36' | 10977 [432.2]  | 12                 | 12                   | 12            |            |   |
| 40' | 12196 [480.2]  | 12                 | 8, 8                 | 12            |            |   |
| 44' | 13415 [528.1]  | 12                 | 12, 8                | 12            |            |   |
| 48' | 14634 [576.1]  | 12                 | 12, 12               | 12            |            |   |

#### LEGEND

- Standard (STD) Wire Entry Location  
(located on back of fixture either: 231 mm from end cap, or 229 mm from end of extursion without end cap)
- Emergency (EM) / Night Light Location  
(4 ft sections)
- EM Wire Entry or Battery Pack Location  
(located 231 mm from end on back of fixture, except on the 4' alone).

Wall bracket

- = 231 [9.1] Distance between end-cap and bracket
- ▲ = 458 [18.0] Distance between brackets at joiners
- A = Distance between brackets
- B = Extrusion lengths (includes end-caps)

EM / Night Light and EM or Battery Wire Entry location in relation to pod selections:

Example 20 ft run

## CROSS SECTIONS

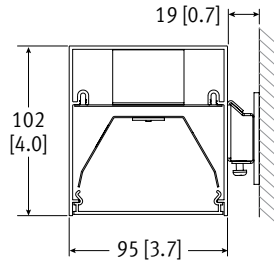

Meta Blanc

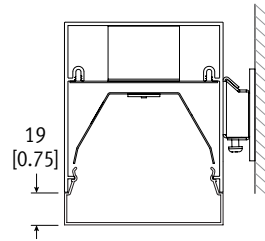

Drop Lens

## SPECIFICATIONS

Due to the Continuous Improvement Policy at Metalumen, we reserve the right to change our specifications without notice.

**Housing:** Rigid extruded aluminum body, 2.0mm (0.08") nominal wall thickness. Steel formed end caps.

**Optical System:** Metalumen luminaires are designed to utilize leading edge LED technology combined with luminaire optimized reflectors and our custom diffusers, resulting in industry leading optical performance.

**CRI:** 80+ for all color temperature ranges.

**Lumen Maintenance:** Minimum 50,000h with TM-21 lumen maintenance of 85% @ 25°C ambient temperature (calculated based on IESNA LM-80-08 LED test data). L70: >60,000hrs.

**Finish:** Satin aluminum and white are standard finishes. For custom finish,

contact factory.

**Weight:** 2.1 kg/300mm [ 4.6 lb/ft ]

**Mounting:** Mounting plate provided.

**Electrical:** Factory prewired with easy wire quick connect sections.

**Drivers:** Metalumen offers 0-10V dimming as a standard on our entire LED product offering. Dimming range is 1%-100%. Power factor is > 90%. Class 2 rating.

**Approvals:** Certified to NRTL and IES testing standards. This product is cULus listed. RoHS compliant.

**Environment:** Suitable for dry or damp locations.

## WARRANTY

Metalumen will warrant defective luminaires for 5 years from date of purchase. Warranty is valid if luminaire is installed and used according to specification. If defective, Metalumen will send replacement boards or drivers at no cost along with detailed replacement instructions and instructions on how to return defective components to Metalumen.