

STAIL RMEP6

LED . PENDANT . DIRECT/INDIRECT

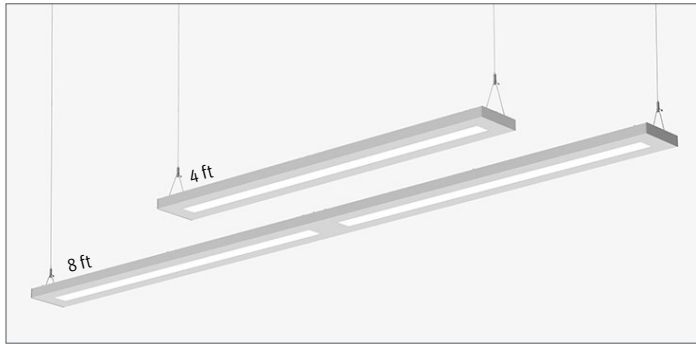

PART #:	
PREP BY:	DATE:
PROJECT:	
NOTES:	
APPROVAL SIGNATURE:	DATE (DD/MM/YYYY):

PERFORMANCE SUMMARY @ 3500K		CM	ODCM	73M	40M	16CM
		L3				
Lumens	80 CRI	5610	5197	5811	5462	5148
	90 CRI	4909	4547	5085	4779	4505
Distribution % (Up / Down)		67 / 33	55 / 45	72 / 28	40 / 60	16 / 84
Wattage		48.6				
Efficacy	80 CRI	115	107	119	112	106
	90 CRI	101	94	105	98	93
L70 Estimate (h)		≥ 60,000 hrs				

See page 2 for the complete Light Level Performance chart. Based on 4 ft sections.

FEATURES

- Efficacy up to 119 LPW
- Available in direct / indirect
- Suitable for dry or damp locations

ORDERING LOGIC

Example Part Number: RMEP6-2L35K-8-CM-WT-L31-PA18-1-D-90

RMEP6											
1	2	3	4	5	6	7	8	9	10	11	
1. SERIES RMEP6	2. COLOR TEMP 2L30K 3000K 2L35K 3500K 2L40K 4000K	3. LENGTH 4 4 ft 8 8 ft RA Continuous Rows Replace "A" with length in feet selected on p2	4. OPTICS CM UP: Clear Optics, Straight Reflector DOWN: Meta Ice (67 up / 33 down) ODCM UP: Opal Optics, Straight Reflector DOWN: Meta Ice (55 up / 45 down) 73M UP: No Optics, Straight Reflector DOWN: Meta Ice (72 up / 28 down) 40M UP: No Optics, Angled Reflector DOWN: Meta Ice (40 up / 60 down) 16CM UP: Clear Optics, Angled Reflector DOWN: Meta Ice (16 up / 84 down) Meta Ice: High output semi-diffuse lens				5. FINISH SG Silver / Grey Textured Coat WT White Textured C Custom Finish Specify RAL:		6. LIGHT LEVEL/DRIVER L1 Select Driver below. L2 L3 See Light Level Performance chart on p2. L4		
7. CIRCUITRY 1 1 Circuit EM Emergency / Night Light * B Emergency Battery Pack * ^B (Remote Mounted)		8. MOUNTING PAA Pendant Aircraft Cable PTA Pendant Aircraft Cable for T-bar Replace "A" with length (inches) selected below. Select Aircraft Cable Length, Canopy Finish & Power Cord Color below		9. VOLTAGE 1 120V 2 277V 3 347V 4 UNV (120 - 277V)		10. CONTROLS / SENSORS _ None (leave space empty) D Wattstopper Daylight Sensor O Wattstopper Occupancy Sensor DO Wattstopper Daylight and Occupancy Sensor			11. OPTIONS 90 90 CRI, High R9 _ None (leave space empty)		

*Two wire entries required. | ^BBattery operates 4ft sections only.

Select Driver:

- Factory option 0-10V, 1% Dimming
- LHE** Lutron H-Series Hi-lume 1% EcoSystem LED Driver
- LA2** Lutron A-Series Hi-lume 1% 2-wire LED Driver
- L5E** Lutron 5-Series EcoSystem LED Driver

Select Aircraft Cable Length:

Total adjustment range is 6" up & down for each standard length. All other lengths are considered custom unless otherwise stated.

Select:	Imperial (in)	Metric (mm)
<input type="checkbox"/>	12	305
<input type="checkbox"/>	18	460
<input type="checkbox"/>	24	610
<input type="checkbox"/>	30	760
<input type="checkbox"/>	36	915
<input type="checkbox"/>	42	1067
<input type="checkbox"/>	48	1220

Select:	Imperial (in)	Metric (mm)
<input type="checkbox"/>	54	1372
<input type="checkbox"/>	60	1525
<input type="checkbox"/>	72	1830
<input type="checkbox"/>	96	2440
<input type="checkbox"/>	120	3050
<input type="checkbox"/>	144	3660
<input type="checkbox"/>	Custom Length: _____	

Select Canopy Finish:

Canopy	
<input type="checkbox"/>	White
<input type="checkbox"/>	Custom Finish
RAL: _____	

Light Level Performance | 3500K, 80 CRI, 0-10V Dimming (Standard), 4ft sections

Optics	CM			ODCM			73M			40M			16CM		
	Lumens	Wattage	Efficacy	Lumens	Wattage	Efficacy	Lumens	Wattage	Efficacy	Lumens	Wattage	Efficacy	Lumens	Wattage	Efficacy
L1	3068	27.8	110	2842	27.8	102	3178	27.8	114	2987	27.8	107	2817	27.8	101
L2	3906	35.4	110	3619	35.4	102	4046	35.4	114	3804	35.4	107	3586	35.4	101
L3	5610	48.6	115	5197	48.6	107	5811	48.6	119	5462	48.6	112	5148	48.6	106
L4	10733	97.2	110	9945	97.2	102	11121	97.2	114	10452	97.2	107	9854	97.2	101

Lumen Adjustment Factor

Color Temp	80 CRI	90 CRI
3000K	0.984	0.873
3500K	1.000	0.875
4000K	1.032	0.879

CONTINUOUS ROWS

Step 1) Indicate desired quantity of rows under the QTY column

Step 2) ← Pods → If applicable, select pod(s) per row to indicate desired Emergency lighting location. If a similar row requires a different Emergency lighting location, please fill out another sheet.

Record drawings for rows not represented here will be sent out upon order.

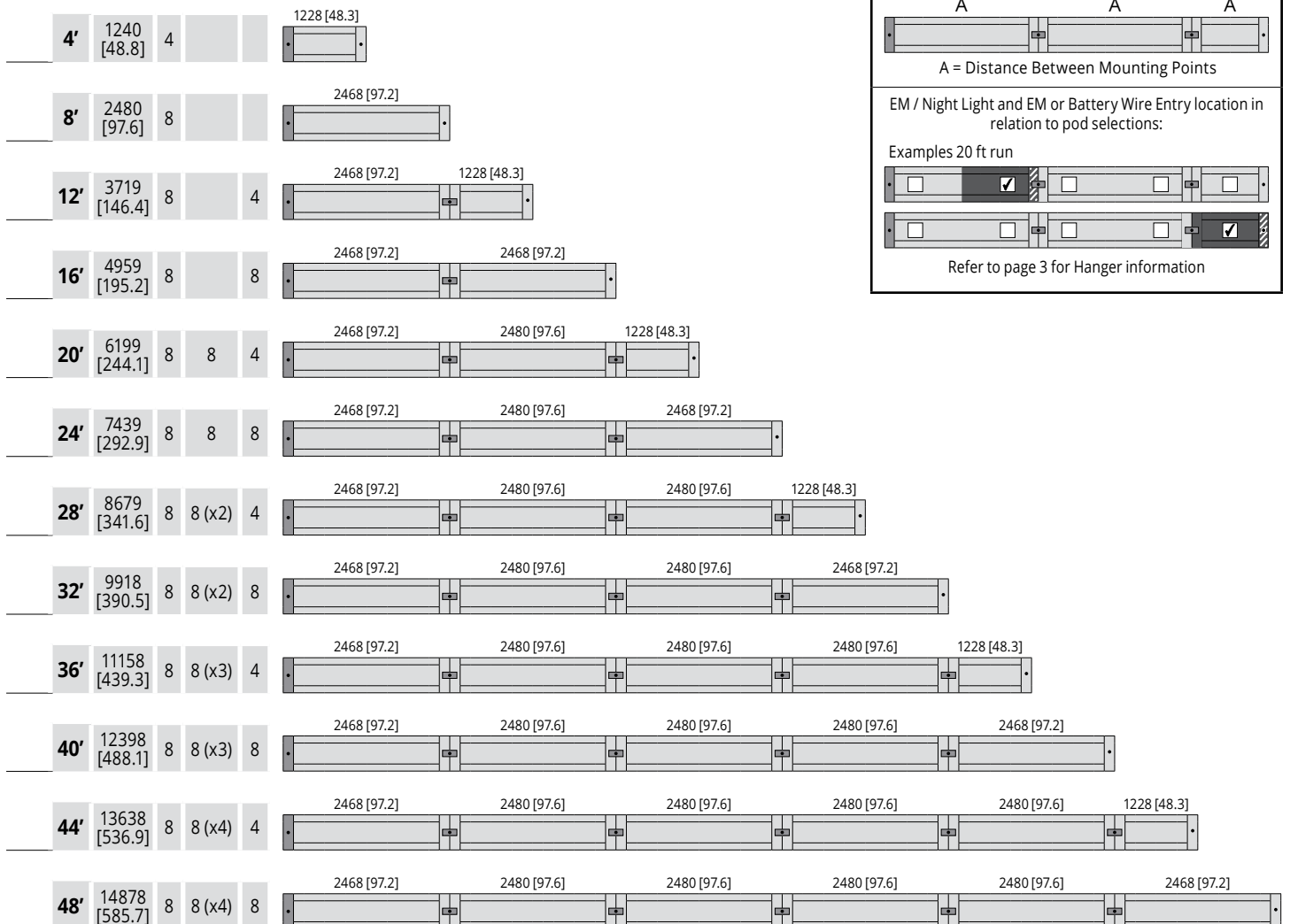



CONTINUOUS ROWS (continued)

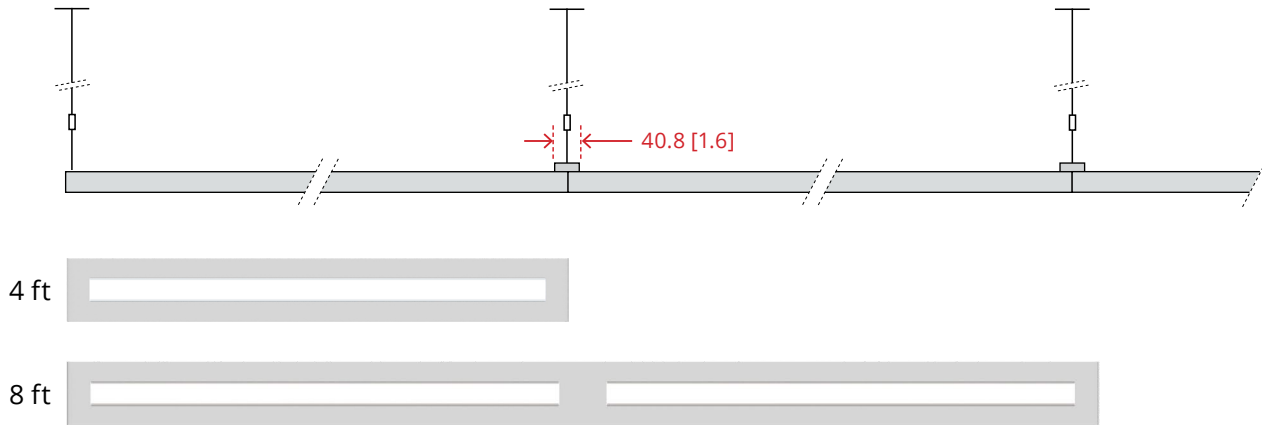

HANGER

Aircraft Cable & Cord

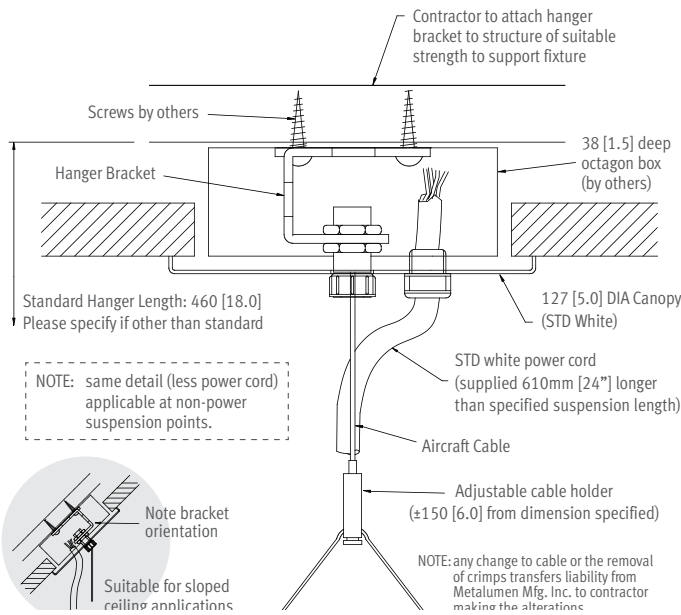

T-Bar Aircraft Cable & Cord

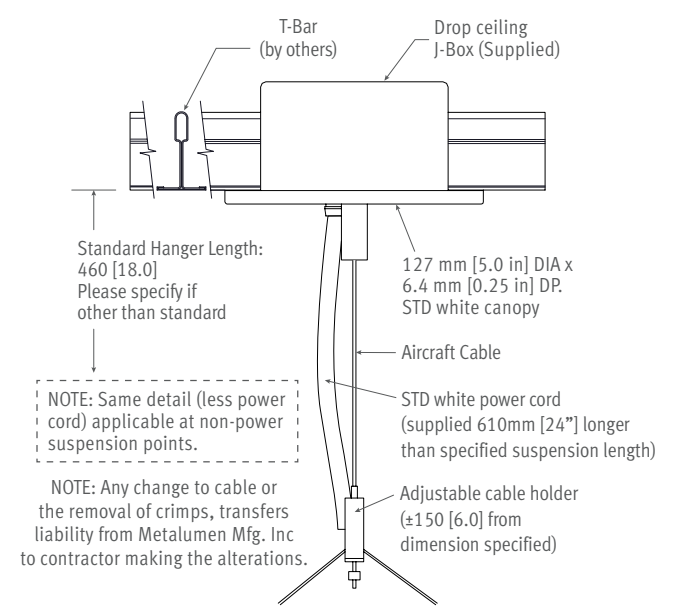

WIRING

Standard Wiring	Emergency Wiring	Emergency Battery Pack Wiring
<p> BLACK - LINE WHITE - NEUTRAL GREEN - GROUND RED - CAPPED/SW LEAD VIOLET - DIM(+) GREY - DIM(-) </p>	<p> BLACK - LINE WHITE - NEUTRAL GREEN - GROUND RED - CAP OFF </p>	<p> BLACK - LINE WHITE - NEUTRAL GREEN - GROUND RED - UNSWITCHED HOT </p>

CROSS SECTIONS

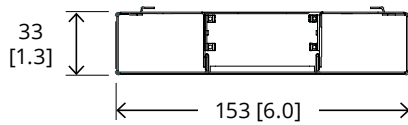

CM
Clear Optics, Straight Reflector



ODCM
Opal Optics, Straight Reflector

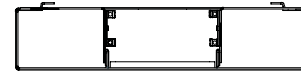

73M
No Optics, Straight Reflector

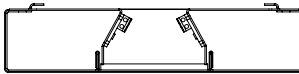

40M
No Optics, Angled Reflector

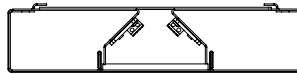

16CM
Clear Optics, Angled Reflector

SPECIFICATIONS

Due to the Continuous Improvement Policy at Metalumen, we reserve the right to change our specifications without notice.

Housing: Cold rolled steel body fabrication, 0.91mm (20 Ga.) wall thickness.

Optical System: MetaLED mid flux LED technology.

CRI: Minimum 83 CRI at 3500K.

Lumen Maintenance: At an ambient operating temperature of 25°C the LED lifetime expectancy \geq 60 000hrs at L70.

Finish: Silver/grey textured and white textured are standard finishes. For custom finish, consult factory.

Weight: 1.8 kg/300mm [4 lb/ft]

Mounting: Aircraft cable with Quick-Grip field adjustable suspension system provides for quick and easy on site alignment.

Electrical: Factory prewired with easy

wire quick connect sections.

Drivers: Metalumen offers 0-10V dimming* as a standard on our entire LED product offering. Dimming range is 1%-100%. Power factor is $>$ 90%. Class 2 rating.

Approvals: All components are UL/CSA/QPS recognized or listed. RoHS compliant.

Environment: Suitable for dry locations.

**Standard drivers compatible with passive/sinking dimmers. Please contact Metalumen if active/sourcing dimmer support is required.*

WARRANTY

Metalumen will warrant defective luminaires for 5 years from date of purchase. Warranty is valid if luminaire is installed and used according to specification. If defective, Metalumen will send replacement boards or drivers at no cost along with detailed replacement instructions and instructions on how to return defective components to Metalumen.

PHOTOMETRIC DATA - 3500K, 80 CRI

Optics Up: **Clear Optics, Straight Reflector**
 Optics Down: **Meta Ice**
 IES File: **RMEP6-2L35K-4-CM-L3**
 Lumens: **5610** Wattage: **48.6**
 Efficacy: **115**

PHOTOMETRIC CURVE
 67% Up
 33% Down

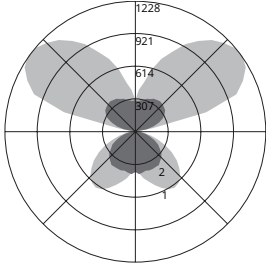

ZONAL LUMEN SUMMARY

Zone	Lumens	%Fixt
0-20	164	2.9
0-30	392	7
0-40	716	12.8
0-60	1433	25.5
0-80	1827	32.6
0-90	1862	33.2
10-90	1823	32.5
20-40	551	9.8
20-50	922	16.4
40-70	975	17.4
60-80	394	7
70-80	137	2.4
80-90	35	0.6
90-110	584	10.4
90-120	1358	24.2
90-130	2143	38.2
90-150	3282	58.5
90-180	3747	66.8
110-180	3163	56.4
0-180	5608	100

COEFFICIENTS OF UTILIZATION

Zonal Cavity Method | Effective Floor Cavity Reflectance = .20

RC	80			70			50					
	RW	70	50	30	10	70	50	30	10	50	30	10
R	0	103	103	103	103	93	93	93	93	74	74	74
R	1	94	89	86	82	84	81	77	75	64	62	60
R	2	85	78	72	66	76	70	65	61	56	52	49
R	3	77	68	61	55	69	61	55	50	49	44	41
R	4	70	60	52	46	63	54	47	42	43	38	34
R	5	64	53	45	39	58	48	41	36	38	33	29
R	6	59	47	39	33	53	43	36	30	34	29	25
R	7	54	42	34	29	49	38	31	26	31	26	22
R	8	50	38	30	25	45	35	28	23	28	23	19
R	9	47	34	27	22	42	31	25	20	25	20	17
R	10	43	31	24	20	39	29	22	18	23	18	15

CANDELA DISTRIBUTION

Vertical Angle	Horizontal Angle				
	0	22.5	45	67.5	90
0	382	382	382	382	382
10	395	395	424	439	449
20	390	407	471	517	540
30	386	432	513	597	627
40	365	417	516	599	632
50	319	367	454	520	539
60	246	276	336	377	395
70	145	164	197	223	226
80	59	62	72	78	80
90	4	3	3	3	3
100	112	242	250	160	163
110	235	498	720	916	1012
120	318	615	931	1113	1200
130	352	628	959	1150	1218
140	365	595	874	1051	1116
150	351	529	744	891	945
160	325	439	586	672	722
170	296	347	421	467	463
180	293	293	293	293	293

LUMINANCE DATA (CD/M²)

Vertical Angle	Horizontal Angle		
	0	45	90
45	2505	3108	3610
55	2443	2917	3276
65	2295	2375	2571
75	1871	1544	1639
85	1118	561	482

Optics Up: **Opal Optics, Straight Reflector**
 Optics Down: **Meta Ice**
 IES File: **RMEP6-2L35K-4-ODCM-L3**
 Lumens: **5197** Wattage: **48.6**
 Efficacy: **107**

PHOTOMETRIC CURVE
 55% Up
 45% Down

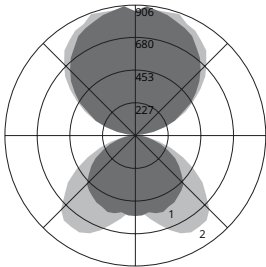

ZONAL LUMEN SUMMARY

Zone	Lumens	%Fixt
0-20	225	4.3
0-30	526	10.1
0-40	937	18
0-60	1824	35.1
0-80	2301	44.2
0-90	2346	45.1
10-90	2292	44.1
20-40	712	13.7
20-50	1174	22.6
40-70	1199	23.1
60-80	476	9.2
70-80	164	3.2
80-90	45	0.9
90-110	287	5.5
90-120	658	12.6
90-130	1135	21.8
90-150	2138	41.1
90-180	2855	54.9
110-180	2567	49.4
0-180	5201	100

COEFFICIENTS OF UTILIZATION

Zonal Cavity Method | Effective Floor Cavity Reflectance = .20

RC	80			70			50					
	RW	70	50	30	10	70	50	30	10	50	30	10
R	0	106	106	106	106	97	97	97	97	81	81	81
R	1	96	92	88	84	88	84	81	78	70	68	66
R	2	87	80	74	68	80	73	68	63	61	57	54
R	3	79	70	62	56	72	64	58	52	53	49	45
R	4	72	61	53	47	66	56	49	44	47	42	38
R	5	66	54	46	40	60	50	43	37	42	36	32
R	6	61	49	40	34	55	45	37	32	37	32	28
R	7	56	44	35	30	51	40	33	28	34	28	24
R	8	52	39	31	26	47	36	29	24	31	25	21
R	9	48	36	28	23	44	33	26	22	28	22	19
R	10	45	33	25	20	41	30	24	19	26	20	17

CANDELA DISTRIBUTION

Vertical Angle	Horizontal Angle				
	0	22.5	45	67.5	90
0	560	560	560	560	560
10	543	570	576	592	590
20	565	575	632	687	700
30	540	578	664	749	777
40	499	545	653	732	770
50	418	470	558	624	638
60	319	347	403	450	468
70	190	207	239	260	261
80	75	77	88	95	93
90	12	11	10	12	11
100	128	128	125	128	126
110	291	292	290	298	296
120	445	446	460	469	464
130	581	588	605	625	634
140	697	710	738	741	764
150	791	804	824	834	834
160	837	844	851	868	893
170	876	871	866	906	877
180	858	858	858	858	858

LUMINANCE DATA (CD/M²)

Vertical Angle	Horizontal Angle		
	0	45	90
45	3443	3821	4392
55	3275	3526	3930
65	2908	2848	3029
75	2295	1852	1870
85	1465	678	640

Optics Up: **No Optics, Straight Reflector**
 Optics Down: **Meta Ice**
 IES File: **RMEP6-2L35K-4-73M-L3**
 Lumens: **5811** Wattage: **48.6**
 Efficacy: **119**

PHOTOMETRIC CURVE
 72% Up
 28% Down

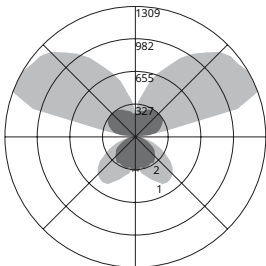

ZONAL LUMEN SUMMARY

Zone	Lumens	%Fixt
0-20	138	2.4
0-30	332	5.7
0-40	609	10.5
0-60	1230	21.2
0-80	1572	27.1
0-90	1603	27.6
10-90	1570	27
20-40	471	8.1
20-50	791	13.6
40-70	844	14.5
60-80	342	5.9
70-80	118	2
80-90	31	0.5
90-110	944	16.3
90-120	1846	31.8
90-130	2661	45.8
90-150	3775	65
90-180	4207	72.4
110-180	3262	56.2
0-180	5809	100

COEFFICIENTS OF UTILIZATION

Zonal Cavity Method | Effective Floor Cavity Reflectance = .20

RC	80			70			50					
	RW	70	50	30	10	70	50	30	10	50	30	10
R	0	102	102	102	102	91	91	91	91	71	71	71
R	1	93	88	84	81	83	79	76	73	62	59	58
R	2	84	77	71	66	75	69	64	59	54	50	47
R	3	76	67	60	54	68	60	54	49	47	43	39
R	4	70	59	51	45	62	53	46	41	41	37	33
R	5	64	52	44	38	56	47	40	35	37	32	28
R	6	58	46	39	33	52	42	35	30	33	28	24
R	7	54	42	34	28	48	37	31	26	29	24	21
R	8	50	38	30	25	44	34	27	23	27	22	18
R	9	46	34	27	22	41	31	24	20	24	19	16
R	10	43	31	24	19	38	28	22	18	22	17	14

CANDELA DISTRIBUTION

Vertical Angle	Horizontal Angle				
	0	22.5	45	67.5	90
0	340	340	340	340	340
10	310	336	344	361	378
20	325	347	395	449	458
30	311	359	444	517	551
40	303	353	443	521	553
50	255	302	398	458	489
60	202	231	287	335	348
70	122	143	172	190	203
80	48	54	62	70	68
90	15	7	5	5	5
100	214	504	517	300	306
110	277	632	936	1191	1309
120	320	660	1009	1213	1306
130	329	625	961	1179	1246
140	327	562	850	1040	1096
150	309	481	707	857	909
160	277	396	547	636	677
170	253	314	380	425	435
180	239	239	239	239	239

LUMINANCE DATA (CD/M²)

Vertical Angle	Horizontal Angle		
	0	45	90
45	2055	2687	3218
55	2076	2528	2966
65	1869	2101	2317
75	1544	1365	1436
85	908	454	384

PHOTOMETRIC DATA - 3500K, 80 CRI

Optics Up: **None, Angled Reflector**
 Optics Down: **Meta Ice**
 IES File: **RMEP6-2L35K-4-40M-L3**
 Lumens: **5462** Wattage: **48.6**
 Efficacy: **112**

PHOTOMETRIC CURVE

40% Up
 60% Down

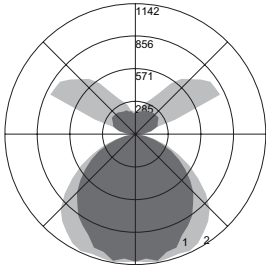

ZONAL LUMEN SUMMARY

Zone	Lumens	%Fixt
0-20	415	7.6
0-30	899	16.4
0-40	1498	27.4
0-60	2669	48.8
0-80	3241	59.3
0-90	3286	60.1
10-90	3180	58.2
20-40	1084	19.8
20-50	1709	31.3
40-70	1551	28.4
60-80	572	10.5
70-80	191	3.5
80-90	46	0.8
90-110	326	6
90-120	858	15.7
90-130	1347	24.7
90-150	1957	35.8
90-180	2178	39.9
110-180	1851	33.9
0-180	5464	100

COEFFICIENTS OF UTILIZATION

Zonal Cavity Method | Effective Floor Cavity Reflectance = .20

RC	80			70			50					
	RW	70	50	30	10	70	50	30	10	50	30	10
RCR												
0	110	110	110	110	102	102	102	102	89	89	89	89
1	100	96	92	88	93	90	86	83	78	76	73	73
2	91	84	77	72	85	78	73	68	69	64	61	61
3	83	73	66	60	77	69	62	57	60	55	51	51
4	76	65	57	51	71	61	54	48	54	48	43	43
5	70	58	49	43	65	54	47	41	48	42	37	37
6	64	52	44	38	60	49	41	36	43	37	32	32
7	59	47	39	33	55	44	37	31	39	33	29	29
8	55	42	34	29	51	40	33	28	36	30	25	25
9	51	39	31	26	48	37	30	25	33	27	23	23
10	48	36	28	23	45	34	27	22	30	24	20	20

CANDELA DISTRIBUTION

Vertical Angle	Horizontal Angle				
	0	22.5	45	67.5	90
0	1111	1111	1111	1111	1111
10	1121	1071	1098	1115	1132
20	1052	1041	1078	1117	1111
30	921	948	1013	1076	1098
40	785	816	895	964	992
50	627	654	723	779	805
60	441	455	504	539	545
70	247	261	276	298	297
80	91	93	98	97	95
90	9	6	5	5	6
100	140	236	70	66	63
110	207	380	604	518	372
120	230	377	603	763	809
130	248	336	551	682	744
140	245	299	428	585	629
150	226	267	325	385	417
160	223	227	260	293	301
170	203	207	210	222	212
180	189	189	189	189	189

LUMINANCE DATA (CD/M²)

Vertical Angle	Horizontal Angle		
	0	45	90
45	5210	5155	5562
55	4707	4434	4623
65	4100	3405	3463
75	3028	2126	2036
85	1689	645	549

Optics Up: **Clear Optics, Angled Reflector**

Optics Down: **Meta Ice**
 IES File: **RMEP6-2L35K-4-16CM-L3**
 Lumens: **5148** Wattage: **48.6**
 Efficacy: **106**

PHOTOMETRIC CURVE

16% Up
 84% Down

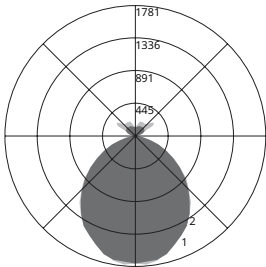

ZONAL LUMEN SUMMARY

Zone	Lumens	%Fixt
0-20	628	12.2
0-30	1313	25.5
0-40	2115	41
0-60	3572	69.3
0-80	4255	82.5
0-90	4310	83.6
10-90	4145	80.4
20-40	1487	28.8
20-50	2279	44.2
40-70	1913	37.1
60-80	683	13.3
70-80	227	4.4
80-90	55	1.1
90-110	68	1.3
90-120	215	4.2
90-130	410	8
90-150	695	13.5
90-180	844	16.4
110-180	777	15.1
0-180	5154	100

COEFFICIENTS OF UTILIZATION

Zonal Cavity Method | Effective Floor Cavity Reflectance = .20

RC	80			70			50					
	RW	70	50	30	10	70	50	30	10	50	30	10
RCR												
0	115	115	115	115	111	111	111	111	102	102	102	102
1	106	101	97	94	101	98	94	91	90	88	85	85
2	97	89	83	77	93	86	80	75	80	75	71	71
3	88	79	71	65	85	76	69	63	70	65	60	60
4	81	70	62	55	78	67	60	54	63	57	52	52
5	75	62	54	48	71	60	53	47	57	50	45	45
6	69	56	48	42	66	55	47	41	51	44	39	39
7	64	51	43	37	61	50	42	36	47	40	35	35
8	60	47	39	33	57	45	38	32	43	36	31	31
9	56	43	35	30	53	42	34	29	39	33	28	28
10	52	39	32	27	50	38	31	26	36	30	26	26

CANDELA DISTRIBUTION

Vertical Angle	Horizontal Angle				
	0	22.5	45	67.5	90
0	1734	1734	1734	1734	1734
10	1710	1713	1693	1686	1720
20	1572	1579	1570	1568	1551
30	1408	1384	1387	1393	1405
40	1154	1154	1151	1166	1179
50	885	874	887	902	910
60	596	595	589	604	613
70	338	327	323	334	322
80	124	114	114	109	112
90	7	4	5	5	6
100	35	27	19	19	19
110	108	115	103	63	63
120	149	156	209	295	274
130	159	195	188	242	280
140	157	201	207	210	218
150	151	186	212	215	216
160	143	155	188	206	216
170	129	135	148	158	154
180	122	122	122	122	122

LUMINANCE DATA (CD/M²)

Vertical Angle	Horizontal Angle		
	0	45	90
45	7425	6461	6268
55	6573	5378	5156
65	5529	4038	3832
75	4086	2486	2268
85	2183	783	699

OPTICS DISTRIBUTION SUMMARY

Cross Section	Part Number	Delivered Lumens	Input Wattage	Efficacy	Direct Lumens	Direct %	Indirect Lumens	Indirect %	Distribution Photometry
---------------	-------------	------------------	---------------	----------	---------------	----------	-----------------	------------	-------------------------

CM = Clear Optics, Straight Reflector (65 Up / 35 Down)

	RMEP6-2L35K-4-CM-XX-L1X-XX-X	3068	27.8	110	1019	33	2049	67	
	RMEP6-2L35K-4-CM-XX-L2X-XX-X	3906	35.2	110	1296	33	2610	67	
	RMEP6-2L35K-4-CM-XX-L3X-XX-X	5610	48.6	115	1862	33	3747	67	
	RMEP6-2L35K-4-CM-XX-L4X-XX-X	10733	97.2	110	3561	33	7170	67	

ODCM = Opal Optics, Straight Reflector (55 Up / 45 Down)

	RMEP6-2L35K-4-ODCM-XX-L1X-XX-X	2842	27.8	102	1283	45	1562	55	
	RMEP6-2L35K-4-ODCM-XX-L2X-XX-X	3619	35.2	102	1633	45	1988	55	
	RMEP6-2L35K-4-ODCM-XX-L3X-XX-X	5197	48.6	107	2346	45	2854	55	
	RMEP6-2L35K-4-ODCM-XX-L4X-XX-X	9945	97.2	102	4495	45	5457	55	

73M = No Optics Straight Reflector (73 Up / 27 Down)

	RMEP6-2L35K-4-73M-XX-L1X-XX-X	3178	27.8	114	877	28	2300	72	
	RMEP6-2L35K-4-73M-XX-L2X-XX-X	4046	35.2	114	1115	28	2929	72	
	RMEP6-2L35K-4-73M-XX-L3X-XX-X	5811	48.6	119	1602	28	4206	72	
	RMEP6-2L35K-4-73M-XX-L4X-XX-X	11121	97.2	114	3065	28	8052	72	

40M = No Optics, Angled Reflector (40 Up / 60 Down)

	RMEP6-2L35K-4-40M-XX-L1X-XX-X	2987	27.8	107	1797	60	1191	40	
	RMEP6-2L35K-4-40M-XX-L2X-XX-X	3804	35.4	107	2289	60	1517	40	
	RMEP6-2L35K-4-40M-XX-L3X-XX-X	5462	48.6	112	3286	60	2178	40	
	RMEP6-2L35K-4-40M-XX-L4X-XX-X	10452	87.2	107	6289	60	4168	40	

16CM = Clear Optics, Angled Reflector (16 Up / 84 Down)

	RMEP6-2L35K-4-16CM-XX-L1X-XX-X	2817	27.8	101	2358	84	462	16	
	RMEP6-2L35K-4-16CM-XX-L2X-XX-X	3586	35.2	101	3004	84	587	16	
	RMEP6-2L35K-4-16CM-XX-L3X-XX-X	5148	48.6	106	4310	84	844	16	
	RMEP6-2L35K-4-16CM-XX-L4X-XX-X	9854	97.2	101	8247	84	1619	16	